

Model

Designation	SC10/10CL	220-240V/50Hz 1~	Sales code:	104L4087
-------------	------------------	------------------	-------------	-----------------

Compressor design

Oil type	Polyolester	Refrigerant(s)	R404A, R507
Oil viscosity	32cST	Displacement	20,58cm ³ / 1,26cu.in
Oil quantity	1233cm ³ / 41,7fl.oz	Compressors on pallet	18
Refr. charge - tech. limit	2200g / 77,6oz		
Free gas volume comp.	2820cm ³ / 95,4fl.oz		
Weight	26,3kg / 58lbs		
Motor protection	1# internal		
Winding resistance main	6,9Ω (at 25°C)		
Winding resistance aux	11Ω (at 25°C)		
Max. winding temp.	125°C / 257°F		
Max. discharge temp.	135°C / 275°F		



General - Configurations with SC10/10CL

	Conf. 1
Motorconfiguration	CSIR
Power supply (nominal)	220-240V/50Hz
Number of phases	1
Voltage range	198-254V
Approvals	CCC, VDE
Starting torque	HST
Note	- / -

Applications with SC10/10CL

	Conf. 1
Refrigerant	R404A
Application	LBP+MBP
System cooling	fan 3m/s
Hot gas defrost	OK
Long interval pull down	OK

Electrical data - Configurations with SC10/10CL

	Conf. 1
Starting device type	relay
Run capacitor	- / -
Start capacitor	80μF
LRA (locked rotor amps / 4s)	2x 23,4A
RLA (rated load amps / 1s)	2x 4,3A
Cut in current	2x 23,4A

Model	
Designation	SC10/10CL 220-240V/50Hz Conf. 1 Sales code: 104L4087

Configuration	Ambient/ machine room temperatures minimum /maximum
Motorconfiguration	CSIR
Power supply (nominal)	220-240V/50Hz 1~
Refrigerant	R404A
Application	LBP+MBP
Voltage range	198-254V
Starting torque	HST
Approvals	CCC, VDE,

Operation Limits

Electrical accessories / wiring diagram

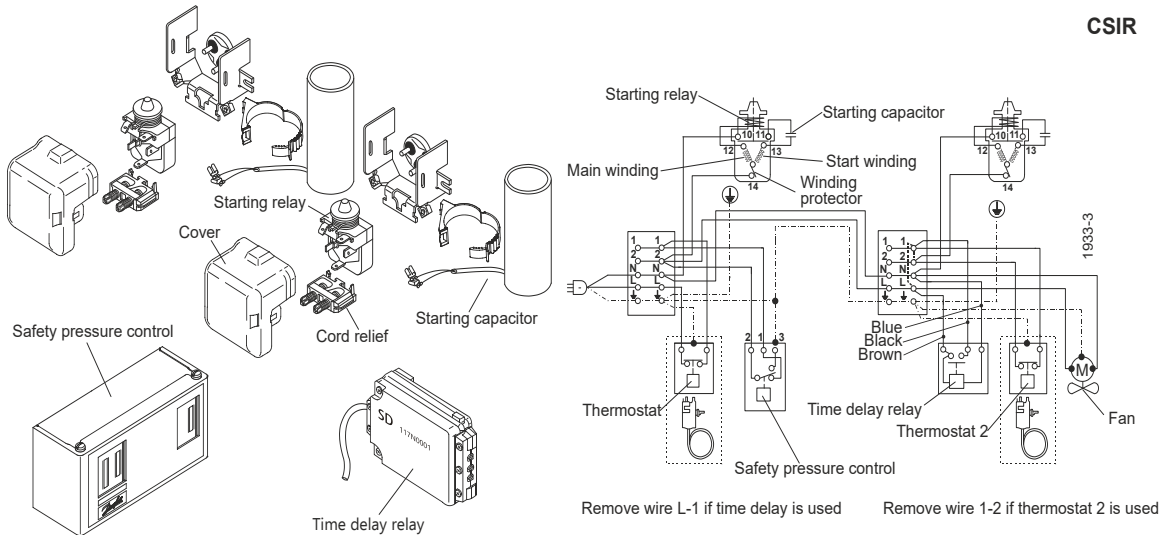

Operation pressure range

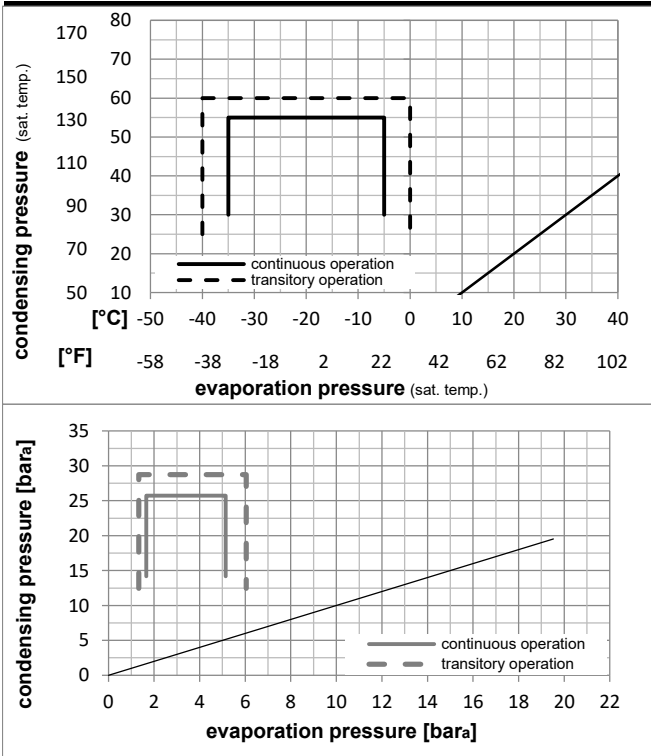

Components

- a2 assy. relay 117U6003
- c start capacitor (80µF) 117U5017
- d cord relief 103N1004
- b plastic cover 103N2009
- . Check valve (to be used with time-delay relay) 020-1014
- . Service valve 12mm 118-7350
- . Solder connector (alternative) 12 mm 104B0584
- . Seal ring for service valve and solder conn. 118-3638

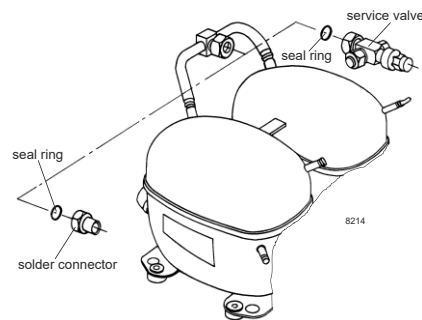

Model

Designation **SC10/10CL** **220-240V/50Hz** Conf. 1 Sales code: **104L4087**

Optimization + standard conditions

R404A, 220V/50Hz, CSIR, fan 3m/s, CCC, VDE

[°C] [°F]	Evaporating pressure (saturation temperature)				Cooling capacity			COP [W/W]	EER [Btu/Wh] [kcal/Wh]	P1 [W]	Power consumption		Ref. mass flow [kg/h]	ASHRAE LBP
	pe	pc	RGT	Tliq	[W]	[Btu/h]	[kcal/h]				I [A]	m		
-23 -10	54 130	32 90	32 90	800,5	2734	688,9	1,13	3,85	0,97	710,5	4,55	18,65	ASHRAE LBP	
-25 -13	55 131	32 90	55 131	522,9	1786	450,0	0,79	2,69	0,68	665,0	4,41	16,34	cecomaf LBP	
-35 -31	40 104	20 68	40 104	393,4	1343	338,5	0,79	2,69	0,68	499,3	3,86	10,69	EN12900 LBP	
-23 -10	49 120	4,4 40	49 120	624,2	2132	537,2	0,85	2,91	0,73	731,8	4,56	22,10	ARI540 LBP	
-23 -10	41 105	32 90	32 90	995,9	3401	857,1	1,34	4,58	1,15	742,2	4,52	23,21	AHAM LBP	
-35 -31	45 113	32 90	45 113	336,1	1148	289,3	0,69	2,36	0,60	485,7	3,82	8,99	opt	

Performance tables

R404A, 220V/50Hz, CSIR, fan 3m/s, CCC, VDE

[°C / °F]	pe		Cooling capacity			COP [W/W]	EER		P1 [W]	I [A]	m [kg/h]
	[°C]	[°F]	[W]	[Btu/h]	[kcal/h]		[Btu/Wh]	[kcal/Wh]			
-35 / -31	-35	-31	336,1	1148	289,3	0,69	2,36	0,60	485,7	3,82	8,99
cond. pressure pc= 45/113	-30	-22	516,9	1765	444,9	0,88	3,01	0,76	587,3	4,11	13,88
return gas temp. RGT= 32/90	-25	-13	729,9	2493	628,2	1,04	3,56	0,90	700,6	4,43	19,69
liquid temp Tliq= 45/113	-23	-10	810,4	2768	697,4	1,09	3,74	0,94	740,9	4,55	21,90
	-20	-4	979,0	3343	842,5	1,19	4,07	1,03	820,5	4,79	26,56
	-15	5	1268,0	4330	1091,2	1,35	4,60	1,16	941,9	5,18	34,64
	-5	23	1981,1	6766	1704,9	1,70	5,79	1,46	1168,4	6,08	55,07
-35 / -31	-35	-31	190,7	651	164,1	0,42	1,45	0,36	449,9	3,68	5,90
cond. pressure pc= 55/131	-30	-22	343,4	1173	295,6	0,63	2,14	0,54	547,4	4,03	10,67
return gas temp RGT= 32/90	-25	-13	522,9	1786	450,0	0,79	2,69	0,68	665,0	4,41	16,34
liquid temp Tliq= 55/131	-23	-10	590,7	2017	508,3	0,83	2,85	0,72	708,7	4,55	18,50
	-20	-4	732,9	2503	630,7	0,92	3,14	0,79	797,6	4,83	23,06
	-15	5	977,2	3337	841,0	1,04	3,55	0,89	940,2	5,29	30,99
	-5	23	1584,2	5410	1363,4	1,28	4,38	1,10	1234,5	6,31	51,28