

## Model

Designation **CU SC15CLX.2 MG\_Z 230/1/50 VAL**



Sales code: 314L4003  
Engineering code: CUSC15CLX20VE

## Application Data

Power supply 220-240V / 50Hz 1~  
Refrigerants R404A-R452A  
Refr. charge - tech. limit 1300g / 45,9oz  
Starter HST / capillary tube or expansion valve  
Sound pressure (10m) 34,6dB(A)

## Configuration data

	Conf. 1	Conf. 2
Voltage range	198 - 254V / 50Hz	198 - 254V / 50Hz
Refrigerant	R404A	R452A
Application	LBP	LBP
Rated performance	<u>pe=-25°C, Tsuc=20°C, Tamb=25°C, subccoling: 2K</u>	
Cooling capacity	732W / 2499Btu/h	688W / 2348Btu/h
Power consumption	563,1W	527,7W
Current consumption	3,7A	3,4A
COP/EER	1,3 / 4,44Btu/Wh	1,3 / 4,45Btu/Wh
Approvals	CE, UK CA, VDE	CE, UK CA, VDE

## Compressor

Designation **SC15CLX.2**  
Motor configuration CSIR  
Locked rotor amperage 20,43A  
Rated load amperage 3,9A  
Winding resistance main 3,7Ω  
Winding resistance aux 14Ω  
Oil quantity 500cm<sup>3</sup> / 16,9fl.oz  
Oil type POE  
Horsepower rating 3/4 HP

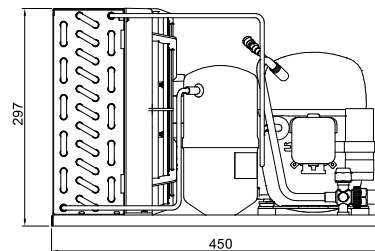

## Dimensions

### Condensing unit

Height x Width x Depth 297 x 350 x 450 [mm] / 11,7 x 13,8 x 17,7 [in]  
Weight 21,8kg / 48lbs  
Suction adapter FLARE 3/8"  
Discharge adapter FLARE 1/4"  
Process connector ø6,2mm / 0,24in

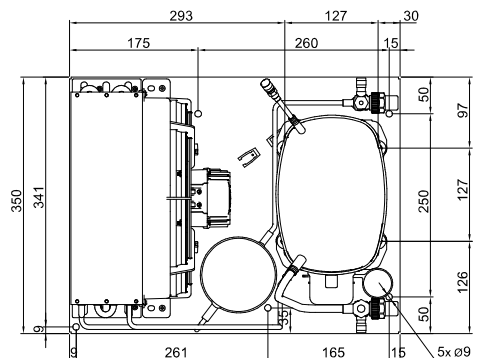

### Package data

Height x Width x Depth 350 x 450 x 550 [mm] / 13,8 x 17,7 x 21,7 [in]  
Weight 24,8kg / 54,6lbs

### Model

Designation **CU SC15CLX.2 MG\_Z 230/1/50 VAL**

Sales code: 314L4003

Engineering code: CUSC15CLX20VE

### Components Condensing-Unit / Spare Parts

Component	Type	Spare part code number
Compressor code	SC15CLX.2	104L2890
Condenser	Condenser (4 rows x 11 tubes)	SP 314S0004
Fan motor		MP 314S0017
Blade code	ø254mm 28°	SP 314S0027
Air flow	576,9m³/h	
Receiver code	Receiver 1,3 liter	MP 314S0036
Suction valve code	FLARE 3/8"	FLARE 3/8"
Liquid valve code	FLARE 1/4"	FLARE 1/4"

Compressor starting equipment	Spare part code number
pos. a2 - relay	117U6019
pos. c - start capacitor (80µF)	117U5017
pos. d - cord relief	103N1004
pos. b - plastic cover	103N2009

### Wiring Sketch Compressor

### Wiring Sketch Condensing Unit

CSIR

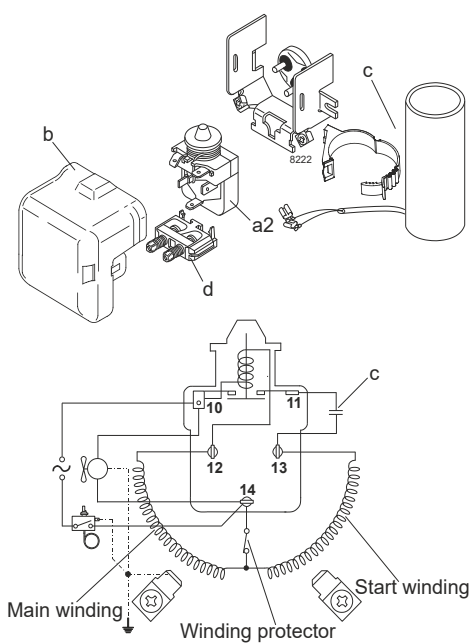

## Model

Designation **CU SC15CLX.2 MG\_Z 230/1/50 VAL**

Sales code: 314L4003

Engineering code: CUSC15CLX20VE

## Cooling performance - Conf. 1

Power supply	220-240V / 50Hz 1~	Voltage range	198 - 254V / 50Hz
Refr. charge - tech. limit	1300g / 45,9oz		
Starter	HST / capillary tube or expansion valve		
Motor configuration	CSIR		
Refrigerant	R404A		
Application	LBP		
Approvals	CE, UK CA, VDE		

ambient temperature	[°C / °F]	25 / 77 (suction gas temperature [°C / °F]: 20 / 68, subcooling: 2K)						
evaporating temperature	[°C / °F]	-45 / -49	-40 / -40	-35 / -31	-30 / -22	-25 / -13	-20 / -4	-10 / 14
cooling capacity	[W]	269	361	469	593	732	885	1226
COP	[W/W]	0,81	0,94	1,06	1,19	1,3	1,4	1,54
cooling capacity	[Btu/h]	917	1231	1600	2024	2499	3023	4186
power consumption	[W]	334	386	441	500	563	633	796
current consumption	[A]	3,1	3,2	3,4	3,5	3,7	4	4,5

ambient temperature	[°C / °F]	32 / 90 (suction gas temperature [°C / °F]: 20 / 68, subcooling: 2K)						
evaporating temperature	[°C / °F]	-45 / -49	-40 / -40	-35 / -31	-30 / -22	-25 / -13	-20 / -4	-10 / 14
cooling capacity	[W]	219	304	403	516	642	780	1086
COP	[W/W]	0,67	0,79	0,91	1,02	1,11	1,2	1,32
cooling capacity	[Btu/h]	749	1040	1377	1762	2192	2663	3707
power consumption	[W]	328	386	445	508	576	650	822
current consumption	[A]	3	3,2	3,4	3,6	3,8	4	4,6

ambient temperature	[°C / °F]	38 / 100 (suction gas temperature [°C / °F]: 20 / 68, subcooling: 2K)						
evaporating temperature	[°C / °F]	-45 / -49	-40 / -40	-35 / -31	-30 / -22	-25 / -13	-20 / -4	
cooling capacity	[W]	176	255	346	449	563	688	
COP	[W/W]	0,55	0,67	0,77	0,87	0,96	1,03	
cooling capacity	[Btu/h]	601	871	1181	1533	1923	2349	
power consumption	[W]	320	383	448	516	588	667	
current consumption	[A]	3	3,2	3,4	3,6	3,8	4,1	

ambient temperature	[°C / °F]	43 / 109 (suction gas temperature [°C / °F]: 20 / 68, subcooling: 2K)						
evaporating temperature	[°C / °F]	-45 / -49	-40 / -40	-35 / -31	-30 / -22	-25 / -13		
cooling capacity	[W]	140	213	297	392	496		
COP	[W/W]	0,45	0,56	0,66	0,75	0,83		
cooling capacity	[Btu/h]	476	729	1016	1338	1694		
power consumption	[W]	311	379	449	521	599		
current consumption	[A]	3	3,2	3,4	3,6	3,8		

## Model

Designation **CU SC15CLX.2 MG\_Z 230/1/50 VAL**

Sales code: 314L4003

Engineering code: CUSC15CLX20VE

## Cooling performance - Conf. 2

Power supply 220-240V / 50Hz 1~ Voltage range 198 - 254V / 50Hz

Refr. charge - tech. limit 1300g / 45,9oz

Starter HST / capillary tube or expansion valve

Motor configuration CSIR

Refrigerant R452A

Application LBP

Approvals CE, UK CA, VDE

ambient temperature	°C / °F	25 / 77							(suction gas temperature [°C / °F]: 20 / 68, subcooling: 2K)
evaporating temperature	[°C / °F]	-45 / -49	-40 / -40	-35 / -31	-30 / -22	-25 / -13	-20 / -4	-10 / 14	
cooling capacity	[W]	244	331	433	553	687	838	1177	
COP	[W/W]	0,79	0,92	1,05	1,18	1,3	1,41	1,56	
cooling capacity	[Btu/h]	832	1129	1480	1887	2348	2861	4021	
power consumption	[W]	310	359	411	467	528	595	754	
current consumption	[A]	2,8	2,9	3	3,2	3,4	3,6	4,2	

ambient temperature	°C / °F	32 / 90							(suction gas temperature [°C / °F]: 20 / 68, subcooling: 2K)
evaporating temperature	[°C / °F]	-45 / -49	-40 / -40	-35 / -31	-30 / -22	-25 / -13	-20 / -4	-10 / 14	
cooling capacity	[W]	198	279	373	482	605	741	1047	
COP	[W/W]	0,65	0,78	0,9	1,02	1,12	1,21	1,34	
cooling capacity	[Btu/h]	675	952	1275	1647	2065	2529	3577	
power consumption	[W]	304	358	414	474	540	611	779	
current consumption	[A]	2,8	2,9	3	3,2	3,4	3,7	4,3	

ambient temperature	°C / °F	38 / 100							(suction gas temperature [°C / °F]: 20 / 68, subcooling: 2K)
evaporating temperature	[°C / °F]	-45 / -49	-40 / -40	-35 / -31	-30 / -22	-25 / -13	-20 / -4	-10 / 14	
cooling capacity	[W]	158	234	321	421	532	656	934	
COP	[W/W]	0,53	0,66	0,77	0,88	0,97	1,05	1,16	
cooling capacity	[Btu/h]	541	798	1097	1437	1819	2240	3189	
power consumption	[W]	296	355	416	481	551	627	804	
current consumption	[A]	2,7	2,9	3	3,2	3,5	3,7	4,4	

ambient temperature	°C / °F	43 / 109							(suction gas temperature [°C / °F]: 20 / 68, subcooling: 2K)
evaporating temperature	[°C / °F]	-45 / -49	-40 / -40	-35 / -31	-30 / -22	-25 / -13	-20 / -4		
cooling capacity	[W]	126	196	277	369	471	584		
COP	[W/W]	0,44	0,56	0,66	0,76	0,84	0,91		
cooling capacity	[Btu/h]	429	670	946	1259	1609	1994		
power consumption	[W]	287	351	417	486	561	641		
current consumption	[A]	2,7	2,9	3	3,2	3,5	3,8		