

Secop strives to be the first choice for partners searching for leading-edge refrigeration solutions and premium customer experience.

Secop is committed to delivering advanced refrigeration compressors and controls, providing customers tailored sustainable solutions for light commercial, battery-driven, and special cooling applications.

HERMETIC COMPRESSORS HFC, HC REFRIGERANTS | 60 Hz



R134a · R513A | R404A · R452A | R290 | R600a

208-230V · 60 Hz
220-240V · 50/60 Hz
200-240V · 50/60 Hz
115-127V · 60 Hz | 110-127V · 50/60 Hz

ENERGY
OPTIMIZED

WIDE APPLICATION
RANGE



Compressor	Code number	Application	ASHRAE Capacity [BTU/h] T _c =130°F, T _{liq} =90°F, T _{suc} =90°F Evaporating temperature [°F]							ASHRAE						Displacement [cu.in]	Voltage and frequencies [*dual frequency type with 50/60 Hz]	Compressor cooling [refer to data sheet]
			LBP rating point -10°F / 130°F		MBP rating point 20°F / 130°F		HBP rating point 45°F / 130°F			Cooling capacity [BTU/h]	EER [BTU/Wh]	Cooling capacity [BTU/h]	EER [BTU/Wh]	Cooling capacity [BTU/h]	EER [BTU/Wh]			
			-31	-13	5	14	32	50										
			ASHRAE Capacity [BTU/h]							Cooling capacity [BTU/h]		EER [BTU/Wh]		Cooling capacity [BTU/h]				
PL30F	101G9100	L/M/HBP	-	89	187	252	422	657	103	2.03	270	4.07	522	6.41	0.09	90-127 V, 60 Hz *	S	
PL50F	101G9202	L/MBP	-	155	290	374	585	-	175	2.70	391	4.42	-	-	0.12	103-127 V, 60 Hz	S	
TL2.5G	102G3255	L/M/HBP	-	169	336	460	788	1226	190	2.65	498	4.91	976	7.46	0.16	103-127 V, 60 Hz	S	
TL2.5F	102G3206	LBP	-	182	339	446	-	-	202	3.12	470	4.53	-	-	0.16	103-127 V, 60 Hz	S	
TL3F	102G3300	LBP	-	228	411	538	-	-	253	3.29	571	4.58	-	-	0.19	103-127 V, 60 Hz	S	
TF3.5F	102G3304	LBP	128	273	502	653	-	-	305	3.26	-	-	-	-	0.22	95-135 V, 60 Hz	S	
TL4G	102G3460	L/M/HBP	-	226	435	576	945	1444	255	2.66	613	4.16	1153	5.85	0.24	90-135 V, 60 Hz *	S	
TFS4F	102G3431	LBP	149	317	600	785	-	-	356	3.66	-	-	-	-	0.24	95-135 V, 60 Hz	S	
TLS4.5F	102G3425	LBP	238	432	760	976	-	-	477	3.70	1018	5.11	-	-	0.28	95-127 V, 60 Hz	S	
TFS4.5FT	102G3432	L/MBP	238	432	760	976	1514	-	477	3.75	1018	5.17	-	-	0.28	95-135 V, 60 Hz	S	
NF5.5FX	105G5623	L/MBP	281	628	1098	1398	2165	-	696	4.12	1454	5.71	-	-	0.37	95-135 V, 60 Hz	F2	
NF6.1FX.2	105G5631	L/MBP	293	648	1161	1490	2315	-	721	4.06	1554	6.09	-	-	0.37	95-135 V, 60 Hz	F1	
NF6FK	105G5628	L/MBP	270	603	1054	1342	2079	-	668	3.88	1396	5.38	-	-	0.37	95-135 V, 60 Hz	F2	
NF7FK	105G5728	L/MBP	383	759	1275	1608	2468	-	834	4.09	1665	5.48	-	-	0.44	95-135 V, 60 Hz	F2	
NF7FX	105G5723	L/MBP	395	783	1314	1657	2545	-	860	4.00	1717	5.54	-	-	0.44	95-135 V, 60 Hz	F2	
NF7.3FX.2	105G5722	L/MBP	387	806	1413	1801	2776	-	893	3.95	1872	5.81	-	-	0.44	95-135 V, 60 Hz	F1	
NF8.4FX.2	105G5918	L/MBP	-	934	1613	2047	3138	-	1031	4.16	2123	5.88	-	-	0.51	95-135 V, 60 Hz	F1	
NF9FX	105G5920	L/MBP	-	852	1454	1848	2864	-	937	3.83	1923	5.54	-	-	0.51	95-135 V, 60 Hz	F2	
NF10FX	105G5941	L/MBP	-	952	1625	2060	3184	-	1048	4.01	2140	5.48	-	-	0.62	95-135 V, 60 Hz	F2	
NF11FX	105G5945	MBP	477	996	1726	2199	3419	-	1100	3.72	2290	5.19	-	-	0.68	95-135 V, 60 Hz	F2	
NF11FX.2	105G5916	MBP	-	-	2054	2615	4025	-	-	-	2717	5.62	-	-	0.69	95-135 V, 60 Hz	F2	
FF6GK	103G5680	L/M/HBP	-	357	796	1101	1886	2907	415	3.15	1195	5.40	2320	7.86	0.38	103-127 V, 60 Hz	F1	
FF7.5GK	103G5780	L/M/HBP	-	452	934	1264	2105	3189	516	3.48	1356	5.41	2556	7.51	0.42	103-127 V, 60 Hz	F1	
FF8.5GX	103G5880	L/M/HBP	-	588	1133	1496	2407	3563	662	3.17	1584	4.94	2871	6.87	0.49	103-127 V, 60 Hz	F2	
FF10GX	103G5980	L/M/HBP	-	634	1235	1637	2652	3953	715	3.08	1737	4.84	3179	6.79	0.55	103-127 V, 60 Hz	F2	
SC12G	104G7250	L/M/HBP	203	873	1799	2395	3927	6016	1007	3.38	2548	5.33	4795	7.64	0.79	103-127 V, 60 Hz	F1	
SC15FTX	104G7505	LBP	677	1406	2412	3051	-	-	1552	3.83	3160	5.00	-	-	0.93	90-135 V, 60 Hz	F2	
SC15G	104G7550	L/M/HBP	-	1085	2183	2898	4663	6882	1237	3.76	3071	5.43	5551	7.24	0.93	103-127 V, 60 Hz	F1	
SC18G	104G7800	L/M/HBP	-	1142	2522	3323	5255	7779	1356	3.36	3496	5.06	6255	6.86	1.08	95-135 V, 60 Hz	F2	

Power [HP]	Dimensions						LST (RSIR & RSCR) refer to data sheet for more info					Run capacitor (RC)		HST (CSIR & CSR) *alt. cable lengths avail.			LST/HST	
	Height [inch]		Connectors location/I.D. [inch]				PTC starting device		PTC starting device with RC connector		ePTC	→ optional → compulsory*		Starting relay	Starting capacitor	Starting device*	Cord relief	Cover
	A	B	Suction C (I.D.)	Process D (I.D.)	Discharge E (I.D.)	alt. connectors available	Spades		Spades		Spades	Spades		Spades				
							1/4 inch	3/16 inch	1/4 inch	3/16 inch	3/16 inch	1/4 inch	3/16 inch	1/4 inch	1/4 inch	1/4 inch		
1/12	5.3	5.2	0.26	0.26	0.20	-	103N0026	103N0023	-	-	-	-	-	117U6000	117U5015	-	103N1010	103N0492
1/12	5.3	5.2	0.26	0.26	0.20	-	103N0026	103N0023	-	-	-	-	-	117U6000	117U5015	-	103N1010	103N0492
1/12	6.4	6.3	0.26	0.26	0.20	X	103N0026	103N0023	-	-	-	-	-	-	-	-	103N1010	103N2011
1/12	6.4	6.3	0.26	0.26	0.20	X	103N0026	103N0023	-	-	-	-	-	-	-	-	103N1010	103N2011
1/12	6.4	6.3	0.26	0.26	0.20	X	-	-	-	-	-	-	-	-	-	-	103N1010	103N2011
1/8	6.8	6.7	0.26	0.26	0.20	X	103N0026	103N0023	-	-	-	-	-	-	-	-	103N1010	103N2011
1/10	6.8	6.7	0.26	0.26	0.20	X	-	-	-	-	-	-	-	-	-	-	103N1010	103N2011
1/8	6.4	6.3	0.26	0.26	0.20	-	103N0026	103N0023	-	-	-	-	-	-	-	-	103N1010	103N2011
1/8	6.8	6.7	0.26	0.26	0.19	X	-	-	-	-	-	-	-	-	-	-	117U0349	117U1021
1/5	7.8	7.5	0.32	0.26	0.26	X	-	-	-	-	-	-	-	-	-	-	117U0349	117U1021
1/5	7.8	7.5	0.32	0.26	0.26	X	-	-	-	-	-	-	-	-	-	-	117U0349	117U1021
1/5	8.0	7.8	0.32	0.26	0.26	X	-	-	-	-	-	-	-	-	-	-	117U0349	117U1021
1/4	8.0	7.8	0.32	0.26	0.26	X	-	-	-	-	-	-	-	-	-	-	117U0349	117U1021
1/4	7.8	7.5	0.32	0.26	0.26	X	-	-	-	-	-	-	-	-	-	-	117U0349	117U1021
1/4	7.8	7.5	0.32	0.26	0.26	X	-	-	-	-	-	-	-	-	-	-	117U0349	117U1021
3/10	7.8	7.5	0.32	0.26	0.26	X	-	-	-	-	-	-	-	-	-	-	117U0349	117U1021
1/4	7.8	7.5	0.32	0.26	0.26	X	-	-	-	-	-	-	-	-	-	-	117U0349	117U1021
3/10	8.0	7.8	0.32	0.26	0.26	X	-	-	-	-	-	-	-	-	-	-	117U0349	117U1021
1/3	8.0	7.8	0.32	0.26	0.26	X	-	-	-	-	-	-	-	-	-	-	117U0349	117U1021
1/5	7.7	7.5	0.32	0.26	0.26	-	-	-	-	-	-	-	-	-	-	-	117U0349	117U1021
1/4	7.7	7.5	0.32	0.26	0.26	-	-	-	-	-	-	-	-	-	-	-	117U0349	117U1021
1/4	7.7	7.5	0.32	0.26	0.26	-	-	-	-	-	-	-	-	-	-	-	117U0349	117U1021
3/10	7.7	7.5	0.32	0.26	0.26	-	-	-	-	-	-	-	-	-	-	-	117U0349	117U1021
2/5	8.2	8.0	0.32	0.26	0.26	X	-	-	-	-	-	-	-	-	-	-	103N1004	103N2008
2/5	8.2	8.0	0.32	0.26	0.26	X	-	-	-	-	-	-	-	-	-	-	103N1004	103N2008
1/2	8.2	8.0	0.32	0.26	0.26	X	-	-	-	-	-	-	-	-	-	-	103N1004	103N2008
3/5	8.6	8.4	0.38	0.26	0.26	-	-	-	-	-	-	-	-	-	-	-	117U0349	117U1021



Alternative refrigerant R5134A, please refer to our data sheets



Compressor	Code number	Application	ASHRAE Capacity [BTU/h] Tc=130°F, Tliq=90°F, Tsuc=90°F Evaporating temperature [°F]						ASHRAE						Displacement [cu.in]	Voltage and frequencies [*dual frequency type with 50/60 Hz]	Compressor cooling (refer to data sheet)
			LBP rating point -10°F / 130°F		MBP rating point 20°F / 130°F		HBP rating point 45°F / 130°F		Cooling capacity [BTU/h]	EER [BTU/Wh]	Cooling capacity [BTU/h]	EER [BTU/Wh]	Cooling capacity [BTU/h]	EER [BTU/Wh]			
			-31	-13	5	14	32	50									
			Cooling capacity [BTU/h]		EER [BTU/Wh]		Cooling capacity [BTU/h]		EER [BTU/Wh]								
PL35G	101G0250	L/M/HBP	-	145	270	349	546	-	163	2.98	364	4.30	-	-	0.12	198-254 V, 60 Hz *	F1
TL2.5G	102G4251	L/M/HBP	60	179	342	447	715	1080	202	2.88	471	4.55	864	6.35	0.16	198-254 V, 60 Hz *	S
TL3G	102G4350	L/M/HBP	-	202	402	530	-	-	231	3.15	562	4.59	-	-	0.19	198-254 V, 60 Hz *	S
TL4G	102G4452	L/M/HBP	-	295	539	701	-	-	329	3.60	737	5.05	-	-	0.24	198-254 V, 60 Hz *	S
TL4GH	102G4455	HBP	-	-	507	682	1123	1716	-	-	728	4.86	1368	6.80	0.24	198-254 V, 60 Hz *	F2
TL5G	102G4550	L/M/HBP	-	387	683	874	-	-	429	3.84	-	-	-	-	0.31	198-254 V, 60 Hz *	S
TLES6.5FT.3	102G4724	LBP	355	664	1130	1438	-	-	729	4.65	-	-	-	-	0.40	198-254 V, 60 Hz *	S
TLES7FT.4	102G4708	LBP	355	664	1130	1438	-	-	729	4.65	-	-	-	-	0.40	198-254 V, 60 Hz *	S
NL6FT	105G6628	LBP	248	502	841	1058	-	-	551	4.16	-	-	-	-	0.37	198-254 V, 60 Hz *	S
NF7FX	105G6743	L/MBP	389	787	1320	1661	2545	-	864	4.02	1719	5.56	-	-	0.44	198-242 V, 60 Hz	F1
NF10FX	105G6846	L/MBP	512	937	1529	1924	2988	-	1021	3.90	1996	5.23	-	-	0.62	198-242 V, 60 Hz *	F2
NL6.1MF	105G6660	L/MBP	185	498	947	1239	1994	-	562	3.97	1308	5.54	-	-	0.37	187-254 V, 60 Hz *	S
NL7.3MF	105G6772	L/MBP	313	677	1199	1539	2418	-	751	4.06	1609	5.42	-	-	0.44	187-254 V, 60 Hz *	F1
NL8.4MF	105G7802	L/MBP	329	759	1377	1779	2819	-	847	4.20	1867	5.53	-	-	0.51	187-254 V, 60 Hz *	F1
NL10MF	105G6885	L/MBP	465	985	1716	2190	3417	-	1090	4.40	2283	5.66	-	-	0.62	187-254 V, 60 Hz *	F1
NLE12.6MF.2	105G6387	L/MBP	1009	1368	2276	2937	4677	-	1481	5.34	3088	7.14	-	-	0.77	198-254 V, 60 Hz *	F2
NLE12.6MFT	105G6388	L/MBP	1009	1368	2276	2937	4677	-	1481	5.34	3088	7.14	-	-	0.77	198-254 V, 60 Hz *	F2
FR6G	103G6660	L/M/HBP	-	394	842	1126	-	-	459	3.60	1199	5.58	-	-	0.38	198-254 V, 60 Hz *	F1
FR7GH	103G6683	M/HBP	-	-	952	1244	2047	3203	-	-	1320	5.53	2537	7.71	0.42	198-254 V, 60 Hz *	F2
FR7.5G	103G6680	L/M/HBP	-	476	962	1268	-	-	547	3.71	1340	5.38	-	-	0.42	198-254 V, 60 Hz *	F1
FR8.5G	103G6780	L/M/HBP	-	586	1113	1458	-	-	661	3.79	1539	5.13	-	-	0.49	198-254 V, 60 Hz *	F1
FR10G	103G6880	L/M/HBP	-	647	1235	1611	-	-	731	3.57	1696	4.93	-	-	0.55	198-254 V, 60 Hz *	F1
SC10G	104G8000	L/M/HBP	119	565	1331	1831	-	-	670	2.95	1972	5.43	-	-	0.63	198-254 V, 60 Hz *	F2
SC10GH	104G8041	HBP	-	-	1361	1793	2909	4446	-	-	1899	5.08	3544	6.89	0.63	198-254 V, 60 Hz *	F2
SC12FT	104G8205	LBP	531	1152	2020	2576	-	-	1276	4.04	2680	5.44	-	-	0.79	198-254 V, 60 Hz *	F1
SC15FT	104G8505	LBP	655	1395	2417	3069	-	-	1542	4.09	3185	5.54	-	-	0.93	198-254 V, 60 Hz *	F2
SC12G	104G8240	L/M/HBP	318	865	1722	2297	-	-	983	3.50	2451	5.47	-	-	0.79	198-254 V, 60 Hz *	F2
SC12G	104G8245	MBP	-	-	1573	2200	3852	6162	-	-	2401	5.65	4860	8.38	0.79	187-254 V, 60 Hz	F2
SC12GH	104G8261	HBP	-	-	1573	2168	3734	5923	-	-	2350	5.52	4680	8.13	0.79	198-254 V, 60 Hz *	F2
SC15G	104G8520	L/M/HBP	-	1114	2182	2867	-	-	1263	3.64	3020	5.58	-	-	0.93	198-254 V, 60 Hz *	F2
SC15G	104G8526	MBP	-	-	1988	2720	4449	6668	-	-	2907	5.69	5348	8.11	0.93	187-254 V, 60 Hz	F2
SC15GH	104G8561	HBP	-	-	1792	2459	4292	6927	-	-	2673	5.70	5449	8.17	0.93	198-254 V, 60 Hz *	F2
SC18FTX	104G8805	LBP	796	1650	2857	3632	-	-	1823	4.11	3774	5.69	-	-	1.08	198-254 V, 60 Hz *	F2
SC18G	104G8820	L/M/HBP	-	1422	2632	3407	-	-	1596	3.86	3572	5.41	-	-	1.08	198-254 V, 60 Hz *	F2
SC18G	104G8823	MBP	-	-	2426	3158	5122	7903	-	-	3336	6.03	6282	8.57	1.08	187-254 V, 60 Hz	F2
SC18GH	104G8861	HBP	-	-	2426	3158	5122	7903	-	-	3336	6.03	6282	8.57	1.08	198-254 V, 60 Hz *	F2
SC18MFX	104G8804	MBP	-	-	2822	3595	5598	8355	-	-	3744	5.96	6697	8.09	1.08	187-254 V, 60 Hz *	F2
SC21FTX	104G8106	LBP	1017	1985	3379	4278	-	-	2184	4.39	4437	5.77	-	-	1.28	187-254 V, 60 Hz	F2
SC21G	104G8140	L/M/HBP	-	1304	2780	3729	-	-	1516	3.67	3980	5.69	-	-	1.28	198-254 V, 60 Hz *	F2
SC21G	104G8143	L/M/HBP	-	1304	2780	3729	-	-	1516	3.67	3980	5.69	-	-	1.28	198-254 V, 60 Hz	F2

Power [HP]	Dimensions						LST (RSIR & RSCR) refer to data sheet for more info					Run capacitor (RC)		HST (CSIR & CSR) *alt. cable lengths avail.			LST/HST	
	Height [inch]		Connectors location/I.D. [inch]				PTC starting device		PTC starting device with RC connector		ePTC	→ optional → compulsory*		Starting relay	Starting capacitor	Starting device*	Cord relief	Cover
	A	B	Suction	Process	Dis-charge	E (I.D.)	Spades		Spades		Spades	Spades		Spades				
			C (I.D.)	D (I.D.)	E (I.D.)	alt. connectors available	1/4 inch	3/16 inch	1/4 inch	3/16 inch	3/16 inch	1/4 inch	3/16 inch	1/4 inch	1/4 inch	1/4 inch		
1/12	5.4	5.3	0.24	0.24	0.20	X	103N0011	103N0018	-	-	-	-	-	117U6021	117U5014	-	103N1010	103N0491
1/12	6.4	6.3	0.24	0.24	0.20	X	103N0011	103N0018	-	-	-	-	-	117U6007	117U5014	-	103N1010	103N2011
1/12	6.4	6.3	0.24	0.24	0.20	X	103N0011	103N0018	-	-	-	-	-	117U6009	117U5014	-	103N1010	103N2010
1/10	6.8	6.7	0.24	0.24	0.20	X	103N0011	103N0018	-	-	-	-	-	117U6004	117U5014	-	103N1010	103N2010
1/10	6.8	6.7	0.24	0.24	0.20	-	-	-	-	-	-	-	-	117U6000	117U5014	-	103N1010	103N2011
1/8	6.8	6.7	0.24	0.24	0.20	X	103N0011	103N0018	-	-	-	-	-	117U6000	117U5014	-	103N1010	103N2010
1/6	6.8	6.7	0.24	0.24	0.20	X	103N0011	103N0018	103N0016	103N0021	-	117-7117	117-7119	117U6016	117U5014	-	103N1010	103N2010
1/6	6.8	6.7	0.26	0.26	0.20	-	103N0011	103N0018	103N0016	103N0021	-	117-7117	117-7119	117U6016	117U5014	-	103N1010	103N2010
1/7	7.8	7.5	0.24	0.24	0.20	-	103N0011	103N0018	-	-	-	-	-	117U6000	117U5015	-	103N1010	103N2010
1/4	8.0	7.8	0.32	0.26	0.26	X	-	-	-	-	-	-	-	117U4140	117U5018	-	117U0349	117U1023
1/4	8.0	7.8	0.32	0.26	0.26	X	-	-	-	-	-	-	-	117U4139	117U5018	-	117U0349	117U1021
1/6	7.5	7.2	0.32	0.24	0.24	X	103N0011	103N0018	-	-	-	-	-	117U6015	117U5015	-	103N1010	103N2011
1/4	7.8	7.5	0.32	0.24	0.24	X	103N0011	103N0018	-	-	-	-	-	117U6016	117U5015	-	103N1010	103N2011
1/4	7.8	7.5	0.32	0.24	0.24	X	103N0011	103N0018	-	-	-	-	-	117U6016	117U5015	-	103N1010	103N2011
3/10	8.0	7.8	0.32	0.24	0.24	X	103N0011	103N0018	-	-	-	-	-	117U6022	117U5018	-	103N1010	103N2011
2/5	8.0	7.8	0.32	0.24	0.24	-	-	-	-	-	103N0050	-	117-7119	117U6005	117U5015	-	103N1010	103N2010
2/5	8.0	7.8	0.32	0.24	0.24	-	-	-	-	-	103N0050	-	117-7119	117U6005	117U5015	-	103N1010	103N2010
1/6	7.7	7.5	0.32	0.24	0.24	-	103N0011	103N0018	-	-	-	-	-	117U6000	117U5015	-	103N1010	103N2010
1/5	7.7	7.5	0.32	0.24	0.32	-	-	-	-	-	-	-	-	117U6016	117U5015	-	103N1010	103N2011
1/5	7.7	7.5	0.32	0.24	0.24	X	103N0011	103N0018	-	-	-	-	-	117U6001	117U5015	-	103N1010	103N2010
1/4	7.7	7.5	0.32	0.24	0.24	-	103N0011	103N0018	-	-	-	-	-	117U6015	117U5015	-	103N1010	103N2010
1/4	7.7	7.5	0.32	0.24	0.24	X	103N0011	103N0018	-	-	-	-	-	117U6010	117U5015	-	103N1010	103N2010
3/10	7.8	7.6	0.32	0.24	0.24	-	103N0011	-	-	-	-	-	-	117U6002	117U5017	-	103N1004	103N2009
3/10	8.2	8.0	0.40	0.24	0.32	-	-	-	-	-	-	-	-	117U6005	117U5017	-	103N1004	103N2008
3/10	8.2	8.0	0.32	0.24	0.24	X	103N0011	-	-	-	-	-	-	117U6003	117U5017	-	103N1004	103N2009
1/3	8.2	8.0	0.40	0.24	0.24	X	103N0011	-	-	-	-	-	-	117U6005	117U5017	-	103N1004	103N2009
1/4	8.2	8.0	0.32	0.24	0.24	X	103N0011	-	-	-	-	-	-	117U6003	117U5017	-	103N1004	103N2009
1/2	8.2	8.0	0.40	0.26	0.26	X	-	-	-	-	-	-	-	117U6011	117U5017	-	103N1004	103N2008
3/8	8.2	8.0	0.40	0.24	0.32	-	-	-	-	-	-	-	-	117U6011	117U5017	-	103N1004	103N2008
2/5	8.2	8.0	0.40	0.24	0.24	X	-	-										

R404A/R507 · 115-127 V · 60 Hz

Compressor	Code number	Application	ASHRAE Capacity [BTU/h] Tc=130°F, Tliq=90°F, Tsuc=90°F Evaporating temperature [°F]						ASHRAE						Displacement [cu.in]	Voltage and frequencies [*dual frequency type with 50/60 Hz]	Compressor cooling cooling (refer to data sheet)		
			LBP rating point -10°F / 130°F		MBP rating point 20°F / 130°F		HBP rating point 45°F / 130°F		Cooling capacity		EER		Cooling capacity					EER	
			-31	-13	5	14	32	50	[BTU/h]	[BTU/Wh]	[BTU/h]	[BTU/Wh]	[BTU/h]	[BTU/Wh]				[BTU/h]	[BTU/Wh]
			[BTU/h]		[BTU/Wh]		[BTU/h]		[BTU/Wh]		[BTU/h]		[BTU/Wh]						
TF4CLX	102U2102	L/MBP	340	642	1059	1320	1965	-	703	3.83	1302	4.77	-	-	0.24	103-135 V, 60 Hz	F2		
TFS4.5CLX	102U2115	LBP	477	852	1369	1692	-	927	4.07	-	-	-	-	-	0.28	103-135 V, 60 Hz	F2		
NF5.5CLX	105F1621	L/MBP	653	1147	1837	2271	3354	-	1247	4.20	2233	5.22	-	-	0.37	95-135 V, 60 Hz	F2		
NF7CLX	105F1721	L/MBP	776	1412	2300	2859	4254	-	1541	4.19	2819	5.33	-	-	0.44	95-135 V, 60 Hz	F2		
SC10CL	104L1503	L/MBP	443	1258	2388	3105	4914	-	1422	3.37	3135	4.86	-	-	0.63	103-127 V, 60 Hz	F2		
SC12CL	104L1603	LBP	771	2131	3744	4691	-	2378	3.78	-	-	-	-	-	0.79	103-127 V, 60 Hz	F2		
SC12CLX.2	104L1696	LBP	1036	2241	3771	4696	-	2470	3.89	4625	4.89	-	-	-	0.79	103-127 V, 60 Hz	F2		
SC12MLX	104L1606	MBP	-	-	3500	4409	6735	-	-	4386	5.20	-	-	-	0.79	95-135 V, 60 Hz	F2		
SC15CLX.2	104L1853	LBP	1409	2739	4564	5704	-	3005	4.12	5636	5.34	-	-	-	0.93	103-127 V, 60 Hz	F2		
SC15MLX	104L1805	MBP	-	-	4101	5165	7886	-	-	5136	4.80	-	-	-	0.93	95-135 V, 60 Hz	F2		
SC15MLX.2	104L1807	MBP	-	-	4212	5246	7892	-	-	5187	5.14	-	-	-	0.93	103-127 V, 60 Hz	F2		
SC18CLX.2	104L2198	LBP	1712	3393	5121	6156	-	3664	4.48	5974	5.31	-	-	-	1.08	103-127 V, 60 Hz	F2		
SC18MLX	104L2105	MBP	-	-	5191	6456	9691	-	-	6378	5.03	-	-	-	1.08	103-127 V, 60 Hz	F2		

Electrical equipment

Power [HP]	Dimensions						LST (RSIR & RSCR) refer to data sheet for more info					Run capacitor (RC)		HST (CSIR & CSR) *alt. cable lengths avail.			LST/HST		
	Height [inch]		Connectors location/I.D. [inch]				PTC starting device		PTC starting device with RC connector		ePTC	→ optional → compulsory*		Starting relay	Starting capacitor	Starting device*	Cord relief	Cover	
	A	B	Suction	Process	Discharge	alt. connectors available	Spades		Spades		Spades	Spades		Spades					
			C (I.D.)	D (I.D.)	E (I.D.)		1/4 inch	3/16 inch	1/4 inch	3/16 inch	3/16 inch	1/4 inch	3/16 inch	1/4 inch	1/4 inch	1/4 inch			
1/5	6.8	6.7	0.26	0.26	0.20	X	-	-	-	-	-	-	-	117U4148	117U5025	-	117U0349	117U1021	
1/4	6.8	6.7	0.26	0.26	0.26	X	-	-	-	-	-	-	-	117U4148	117U5025	-	-	-	
1/3	8.0	7.8	0.32	0.26	0.26	X	-	-	-	-	-	-	-	117U4061	117U5025	-	117U0349	117U1021	
2/5	7.8	7.5	0.32	0.26	0.26	X	-	-	-	-	-	-	-	117U4129	117U5022	-	117U0349	117U1021	
3/8	8.2	8.0	0.32	0.26	0.26	X	-	-	-	-	-	-	-	117U6020	117U5023	-	103N1004	103N2008	
3/5	8.2	8.0	0.32	0.26	0.26	X	-	-	-	-	-	-	-	117U6020	117U5023	-	103N1004	103N2008	
3/5	8.2	8.0	0.32	0.26	0.26	X	-	-	-	-	-	-	-	117U6020	117U5023	-	103N1004	103N2008	
3/5	8.6	8.4	0.32	0.26	0.26	-	-	-	-	-	-	-	117-7133	-	117-7441	117U5042	117-7053	-	117U1021
5/6	8.6	8.4	0.38	0.26	0.26	-	-	-	-	-	-	-	117-7114	-	117-7441	117U5043	117-7045	-	117U1021
5/6	8.6	8.4	0.38	0.26	0.26	-	-	-	-	-	-	-	117-7114	-	117-7441	117U5043	117-7045	-	117U1021
5/6	8.6	8.4	0.38	0.26	0.26	-	-	-	-	-	-	-	117-7114	-	117-7441	117U5043	117-7045	-	117U1021
1	8.6	8.4	0.38	0.26	0.26	X	-	-	-	-	-	-	117-7114	-	117-7441	117U5043	117-7045	-	117U1021
1	8.6	8.4	0.38	0.26	0.26	-	-	-	-	-	-	-	117-7114	-	117-7441	117U5043	117-7045	-	117U1021

R404A/R507 · 220-240 V · 50/60 Hz | 208-230 V · 60 Hz

Compressor	Code number	Application	ASHRAE Capacity [BTU/h] Tc=130°F, Tliq=90°F, Tsuc=90°F Evaporating temperature [°F]						ASHRAE						Displacement [cu.in]	Voltage and frequencies [*dual frequency type with 50/60 Hz]	Compressor cooling cooling (refer to data sheet)		
			LBP rating point -10°F / 130°F		MBP rating point 20°F / 130°F		HBP rating point 45°F / 130°F		Cooling capacity		EER		Cooling capacity					EER	
			-31	-13	5	14	32	50	[BTU/h]	[BTU/Wh]	[BTU/h]	[BTU/Wh]	[BTU/h]	[BTU/Wh]				[BTU/h]	[BTU/Wh]
			[BTU/h]		[BTU/Wh]		[BTU/h]		[BTU/Wh]		[BTU/h]		[BTU/Wh]						
NF7MLX	105F3720	MBP	-	-	2260	2843	4291	-	-	2819	5.33	-	-	0.44	187-254 V, 60 Hz *	F2			
NL6.1MLX	105F3611	MBP	-	-	1853	2331	3518	-	-	2311	5.52	-	-	0.37	187-254 V, 60 Hz *	F2			
SC10CLX	104L2533	L/MBP	529	1576	2786	3489	-	1763	3.95	-	-	-	-	0.63	198-254 V, 60 Hz *	F2			
SC10MLX	104L2506	MBP	-	1620	2874	3650	5578	-	1805	3.91	3636	5.22	-	-	0.63	187-254 V, 60 Hz *	F2		
SC12CLX	104L2695	LBP	771	2131	3744	4691	-	2378	4.20	-	-	-	-	0.79	198-254 V, 60 Hz	F2			
SC12CLX.2	104L2699	LBP	1081	2187	3704	4652	-	2408	4.33	-	-	-	-	0.79	187-254 V, 60 Hz	F2			
SC12CLX.2	104L2697	LBP	1081	2187	3704	4652	-	2408	4.07	-	-	-	-	0.79	198-254 V, 60 Hz *	F2			
SC12MLX	104L2606	MBP	-	1998	3445	4339	6563	-	2212	4.02	4305	5.18	-	-	0.79	187-254 V, 60 Hz *	F2		
SC15CLX	104L2854	LBP	800	2360	4141	5179	-	2636	4.20	-	-	-	-	0.93	198-254 V, 60 Hz	F2			
SC15CLX.2	104L2897	LBP	1409	2739	4564	5704	-	3005	4.53	-	-	-	-	0.93	187-254 V, 60 Hz	F2			
SC15MLX.2	104L2803	MBP	-	-	4210	5243	7918	-	-	5188	5.32	-	-	0.93	187-254 V, 60 Hz	F2			
SC18CLX.2	104L2195	LBP	1774	3516	5306	6379	-	3797	4.76	-	-	-	-	1.08	187-254 V, 60 Hz	F2			
SC18MLX	104L2138	MBP	-	-	5191	6456	9691	-	-	6378	5.03	-	-	1.08	187-254 V, 60 Hz	F2			
SC12/12CLX	104L4034	LBP	1533	4240	7450	9334	-	4733	4.18	-	-	-	-	1.57	198-254 V, 60 Hz	F2			
GS21CLX	107B0506	LBP	1993	3902	6548	8216	-	4286	4.60	-	-	-	-	1.29	187-254 V, 60 Hz	F2			
GS21MLX	107B0509	MBP	-	4156	6973	8695	13036	-	4580	4.99	8587	6.34	-	-	1.29	187-254 V, 60 Hz	F2		
GS26CLX	107B0505	LBP	2453	4456	7216	8995	-	4854	4.14	-	-	-	-	1.60	187-254 V, 60 Hz	F2			

Electrical equipment

Power [HP]	Dimensions						LST (RSIR & RSCR) refer to data sheet for more info					Run capacitor (RC)		HST (CSIR & CSR) *alt. cable lengths avail.			LST/HST	
	Height [inch]		Connectors location/I.D. [inch]				PTC starting device		PTC starting device with RC connector		ePTC	→ optional → compulsory*		Starting relay	Starting capacitor	Starting device*	Cord relief	Cover
	A	B	Suction	Process	Discharge	alt. connectors available	Spades		Spades		Spades	Spades		Spades				
			C (I.D.)	D (I.D.)	E (I.D.)		1/4 inch	3/16 inch	1/4 inch	3/16 inch	3/16 inch	1/4 inch	3/16 inch	1/4 inch	1/4 inch	1/4 inch		
2/5	8.0	7.8	0.38	0.26	0.26	X	-	-	-	-	-	-	-	117U4139	117U5018	-	117U0349	117U1021
1/3	8.0	7.8	0.32	0.26	0.26	X	-	-	-	-	-	-	-	117U6022	117U5015	-	103N1010	103N2011
3/8	8.2	8.0	0.32	0.24	0.24	X	-	-	-	-	-	-	-	117U6005	117U5017	-	103N1004	103N2008
3/8	8.2	8.0	0.32	0.26	0.26	-	-	-	-	-	-	-	-	117U6011	117U5017	-	103N1004	103N2008
3/5	8.6	8.4	0.32	0.24	0.24	X	-	-	-	-	-	-	-	117U6019	117U5017	-	103N1004	103N2008
3/4	8.6	8.4	0.38	0.26	0.26	X	-	-	-	-	-	-	-	-	-	117-7027	103N1004	103N2008
3/5	8.6	8.4	0.32	0.24	0.24	X	-	-	-	-	-	-	-	117U6019	117U5017	-	103N1004	103N2008
1/2	8.6	8.4	0.32	0.26	0.26	-	-	-	-	-	-	-	-	117U6011	117U5017	-	103N1004	103N2008
3/4	8.6	8.4	0.40	0.24	0.24	-	-	-	-	-	-	-	-	117U5373	117-7039	103N1004	103N2008	
5/6	8.6	8.4	0.38	0.26	0.26	X	-	-	-	-	-	-	-	117U5373	117-7039	103N1004	103N2008	
5/6	8.6	8.4	0.38	0.26	0.26	-	-	-	-	-	-	-	-	-	-	117-7058	103N1004	103N2008
1	8.6	8.4	0.38	0.26	0.26	X	-	-	-	-	-	-	-	117U5373	117-7066	103N1004	103N2008	
1	8.6	8.4	0.38	0.26	0.26	-	-	-	-	-	-	-	-	-	-	117-7066	103N1004	103N2008
1 1/4	10.2	10.0	0.47	0.24	0.24	-	-	-	-	-	-	-	-	117U6019	117U5017	-	103N1004	103N2009
1 1/4	10.2	9.7	0.51	0.26	0.32	-	-	-	-	-	-	-	-	-	-	117-7073	-	107B9101
1 1/4	11.0	10.5	0.51	0.26	0.38	-	-	-	-	-	-	-	-	-	-	117-7073	-	107B9106
1 1/4	11.0	10.5	0.51	0.26	0.32	-	-	-	-	-	-	-	-	-	-	117-7073	-	107B9101



Alternative refrigerant R452A, please refer to our data sheets



R452A

R600a · 115-127 V · 60 Hz

Compressor	Code number	Application	ASHRAE Capacity [BTU/h] Tc=130°F, Tliq=90°F, Tsuc=90°F Evaporating temperature [°F]						ASHRAE						Displacement [cu.in]	Voltage and frequencies [*dual frequency type with 50/60 Hz]	Compressor cooling cooling (refer to data sheet)		
			LBP rating point -10°F / 130°F		MBP rating point 20°F / 130°F		HBP rating point 45°F / 130°F		Cooling capacity		EER		Cooling capacity					EER	
			-31	-13	5	14	32	50	[BTU/h]	[BTU/Wh]	[BTU/h]	[BTU/Wh]	[BTU/h]	[BTU/Wh]				[BTU/h]	[BTU/Wh]
NLE11KTK	105H5942	L/MBP	360	602	1059	1342	1959	-	665	4.18	1390	5.70	-	-	0.68	95-135 V, 60 Hz	F1		
NLE13KTK	105H5949	L/MBP	415	707	1182	1487	2227	-	773	4.13	1545	5.52	-	-	0.81	95-135 V, 60 Hz	F1		

R600a · 220-240 V · 50/60 Hz

Compressor	Code number	Application	ASHRAE Capacity [BTU/h] Tc=130°F, Tliq=90°F, Tsuc=90°F Evaporating temperature [°F]						ASHRAE						Displacement [cu.in]	Voltage and frequencies [*dual frequency type with 50/60 Hz]	Compressor cooling cooling (refer to data sheet)		
			LBP rating point -10°F / 130°F		MBP rating point 20°F / 130°F		HBP rating point 45°F / 130°F		Cooling capacity		EER		Cooling capacity					EER	
			-31	-13	5	14	32	50	[BTU/h]	[BTU/Wh]	[BTU/h]	[BTU/Wh]	[BTU/h]	[BTU/Wh]				[BTU/h]	[BTU/Wh]
NLE9KTK	105H6071	LBP	262	473	801	1022	-	-	519	4.41	-	-	-	-	0.51	198-253 V, 60 Hz *	S		
NLE11KTK	105H6948	LBP	349	609	992	1259	-	-	662	4.39	-	-	-	-	0.68	198-254 V, 60 Hz *	S		

K-Series AT · R600a · 200-240 V · 50/60 Hz

Compressor	Code number	Application	ASHRAE Capacity [BTU/h] Tc=130°F, Tliq=90°F, Tsuc=90°F Evaporating temperature [°F]						ASHRAE						Displacement [cu.in]	Voltage and frequencies [*dual frequency type with 50/60 Hz]	Compressor cooling cooling (refer to data sheet)		
			LBP rating point -10°F / 130°F		MBP rating point 20°F / 130°F		HBP rating point 45°F / 130°F		Cooling capacity		EER		Cooling capacity					EER	
			-31	-13	5	14	32	50	[BTU/h]	[BTU/Wh]	[BTU/h]	[BTU/Wh]	[BTU/h]	[BTU/Wh]				[BTU/h]	[BTU/Wh]
HXK80AT	CD000135	LBP	291	526	851	1054	-	-	573	6.04	-	-	-	-	0.49	198-253 V, 60 Hz *	S		
HXK87AT	CD000136	LBP	365	577	934	1158	-	-	627	6.04	-	-	-	-	0.54	198-253 V, 60 Hz *	S		
HXK95AT	CD000137	LBP	399	630	1020	1265	-	-	685	6.04	-	-	-	-	0.59	198-253 V, 60 Hz *	S		
HXK12AT	CD000219	LBP	468	741	1196	1492	-	-	805	5.97	-	-	-	-	0.68	198-253 V, 60 Hz *	S		
HXK13AT	CD000222	LBP	517	819	1321	1648	-	-	889	5.69	-	-	-	-	0.76	198-253 V, 60 Hz *	S		

R290 · 115-127 V · 60 Hz

Compressor	Code number	Application	ASHRAE Capacity [BTU/h] Tc=130°F, Tliq=90°F, Tsuc=90°F Evaporating temperature [°F]						ASHRAE						Displacement [cu.in]	Voltage and frequencies [*dual frequency type with 50/60 Hz]	Compressor cooling cooling (refer to data sheet)		
			LBP rating point -10°F / 130°F		MBP rating point 20°F / 130°F		HBP rating point 45°F / 130°F		Cooling capacity		EER		Cooling capacity					EER	
			-31	-13	5	14	32	50	[BTU/h]	[BTU/Wh]	[BTU/h]	[BTU/Wh]	[BTU/h]	[BTU/Wh]				[BTU/h]	[BTU/Wh]
TL4CNX.2	102H3490	L/MBP	365	664	1058	1305	1929	-	722	4.31	1336	6.12	-	-	0.24	95-135 V, 60 Hz	F2		
DLE4CN	102H3482	L/MBP	436	725	1130	1387	2030	-	783	5.11	1415	6.94	-	-	0.24	95-135 V, 60 Hz	F2		
DLE4.8CN	102H3582	L/MBP	526	899	1392	1696	2446	-	972	5.00	1722	6.82	-	-	0.29	95-135 V, 60 Hz	F2		
DLE5.7CN	102H3682	L/MBP	660	1101	1689	2052	2945	-	1188	5.10	2080	6.69	-	-	0.35	95-135 V, 60 Hz	F2		
DLE6.5CN	102H3792	L/MBP	697	1189	1832	2241	3295	-	1283	5.11	2286	6.69	-	-	0.40	95-135 V, 60 Hz	F2		
NL8.4CNX.2	105H6090	L/MBP	909	1534	2384	2919	4259	-	1658	5.01	2975	6.55	-	-	0.51	95-135 V, 60 Hz	F2		
NLE8.0CN	105H6093	L/MBP	831	1431	2214	2705	3952	-	1546	5.36	2756	7.08	-	-	0.49	95-135 V, 60 Hz	F2		
NLE8.8CN	105H6094	L/MBP	1007	1621	2518	3076	4424	-	1751	5.37	3125	7.11	-	-	0.53	95-135 V, 60 Hz	F2		
NLE10CN	105H6194	L/MBP	1184	1921	2962	3604	5145	-	2073	5.20	3651	6.98	-	-	0.62	103-127 V, 60 Hz	F2		
NLE11CNL	105H5981	LBP	1306	2118	3297	4006	-	-	2291	5.54	-	-	-	-	0.68	95-135 V, 60 Hz	F2		
NLE11MN	105H5980	MBP	-	2104	3331	4055	5790	8007	2292	5.24	4106	6.97	6558	9.38	0.68	95-127 V, 60 Hz	F2		
SC10CNX.2	104H7070	L/MBP	531	1361	2480	3172	4868	-	1525	3.98	3302	6.38	-	-	0.63	95-135 V, 60 Hz	F2		
SC12CNX.2	104H7270	L/MBP	961	1902	3171	3955	5876	-	2088	4.40	4065	6.39	-	-	0.79	95-135 V, 60 Hz	F2		
SC15MNX	104H7570	MBP	-	2070	3945	4772	6744	-	2429	4.25	4795	6.04	-	-	0.93	100-127 V, 60 Hz	F2		
SC18MNX	104H7870	MBP	-	2838	4415	5343	7780	-	3090	4.65	5419	6.22	-	-	1.08	103-127 V, 60 Hz	F2		
SCE15CNLX	104H7578	LBP	966	2467	4169	5158	-	-	2731	5.38	5269	7.36	-	-	0.93	103-127 V, 60 Hz	F2		
SCE18CNLX	104H7878	LBP	1257	2937	4824	6010	-	-	3223	5.56	6209	7.36	-	-	1.08	103-127 V, 60 Hz	F2		
SCE21CNLX	104H7178	LBP	1615	3397	5530	6824	-	-	3720	5.47	6981	7.12	-	-	1.28	103-127 V, 60 Hz	F2		
SCE15MNX	104H7579	MBP	-	-	4073	5099	7534	-	-	-	5241	6.99	-	-	0.93	103-127 V, 60 Hz	F2		
SCE18MNX	104H7879	MBP	-	-	4854	6013	8728	-	-	-	6134	7.26	-	-	1.08	103-127 V, 60 Hz	F2		

Power	Dimensions					LST (RSIR & RSCR) refer to data sheet for more info					Run capacitor (RC)		HST (CSIR & CSR) *alt. cable lengths avail.			LST/HST		
	Height [inch]		Connectors location/I.D. [inch]			PTC starting device		PTC starting device with RC connector		ePTC	→ optional → compulsory*		Starting relay	Starting capacitor	Starting device*	Cord relief	Cover	
	[HP]	A	B	Suction C (I.D.)	Process D (I.D.)	Dis-charge E (I.D.)	alt. connectors available	Spades	Spades	Spades	Spades	Spades	Spades	Spades				
1/6	7.8	7.5	0.32	0.26	0.26	-	103N0026	103N0023	103N0027	103N0024	-	117-7118	117-7120	-	-	-	103N1010	103N2011
1/5	7.8	7.5	0.32	0.26	0.26	-	103N0026	103N0023	103N0027	103N0024	-	117-7118	117-7120	-	-	-	103N1010	103N2011

Electrical equipment

Power	Dimensions					LST (RSIR & RSCR) refer to data sheet for more info					Run capacitor (RC)		HST (CSIR & CSR) *alt. cable lengths avail.			LST/HST		
	Height [inch]		Connectors location/I.D. [inch]			PTC starting device		PTC starting device with RC connector		ePTC	→ optional → compulsory*		Starting relay	Starting capacitor	Starting device*	Cord relief	Cover	
	[HP]	A	B	Suction C (I.D.)	Process D (I.D.)	Dis-charge E (I.D.)	alt. connectors available	Spades	Spades	Spades	Spades	Spades	Spades					
1/4	7.8	7.5	0.24	0.24	0.20	X	103N0011	103N0018	103N0016	103N0021	-	117-7117	117-7119	-	-	-	103N1010	103N2010
1/6	7.8	7.5	0.24	0.24	0.20	-	103N0011	103N0018	103N0016	103N0021	-	117-7117	117-7119	-	-	-	103N1010	103N2010

Electrical equipment · Spare parts · Accessories

Power	Dimensions					Run capacitor	Terminal board	Terminal board	Cable clamp	Cover	Evaporation tray	All-in-one equipment		
	Height [mm]		Connectors location [mm]			→ optional → compulsory*	→ PTC → external protector	→ ePTC → external protector	screws not included	V0	plastic	→ cover → cable clamp + screws → earthing screw		
	[HP]	A	B	Suction C (I.D.)	Process D (O.D.)	Dis-charge E (I.D.)	alt. connectors available	Spades	Spades	Spades	material optional			
1/6	6.6	-	0.24	0.24	0.20	X	4 µF	ZCF5	DCF5	-	113410_	157595_	162991_	161680_
1/6	6.6	-	0.24	0.24	0.20	X	4 µF	ZCFC	DCFC	-	113410_	157595_	162991_	161680_
1/5	6.6	-	0.24	0.24	0.20	X	4 µF	ZCFP	DCFP	-	113410_	157595_	162991_	161680_
1/4	6.6	-	0.24	0.24	0.20	X	4 µF	ZCF9	DCF9	-	113410_	157595_	162991_	161680_
1/4	6.7	-	0.24	0.24	0.20	X	4 µF	ZCF9	DCF9	-	113410_	157595_	162991_	161680_

Electrical equipment

Power	Dimensions					LST (RSIR & RSCR) refer to data sheet for more info					Run capacitor (RC)		HST (CSIR & CSR) *alt. cable lengths avail.			LST/HST			
	Height [inch]		Connectors location/I.D. [inch]			PTC starting device		PTC starting device with RC connector		ePTC	→ optional → compulsory*		Starting relay	Starting capacitor	Starting device*	Cord relief	Cover		
	[HP]	A	B	Suction C (I.D.)	Process D (I.D.)	Dis-charge E (I.D.)	alt. connectors available	Spades	Spades	Spades	Spades	Spades	Spades						
1/5	6.8	6.7	0.26	0.26	0.20	-	-	-	-	-	-	-	-	-	117U7005	117U5023	-	103N1010	103N2011
1/5	6.9	6.7	0.32	0.26	0.26	X	-	-	-	-	103N0058	117-7118	117-7120	117U7022	117U5023	-	103N1010	103N0492	
1/4	6.9	6.7	0.32	0.26	0.26	X	-	-	-	-	103N0058	117-7118	117-7120	117U7011	117U5023	-	103N1010	103N0492	
1/3	6.9	6.7	0.32	0.26	0.26	X	-	-	-	-	103N0058	117-7118	117-7120	117U7011	117U5023	-	103N1010	103N0492	
1/3	6.9	6.7	0.32	0.26	0.26	X	-	-	-	-	103N0058	117-7118	-	117U7013	117U5023	-	103N1010	103N0492	
2/5	8.0	7.8	0.32	0.26	0.26	X	-	-	-	-	-	-	-	117U7013	117U5035	-	103N1010	103N2011	
1/2	8.0	7.8	0.32	0.26	0.26	X	-	-	-	-	103N0058	117-7147	117-7146	117U7013	117U5023	-	103N1010	103N2011	
3/5	8.0	7.8	0.32	0.26	0.26	X	-	-	-	-	103N0058	117-7114	-	117U7014	117U5025	-	103N1010	103N2011	
3/5	8.0	7.8	0.32	0.26	0.26	X	-	-	-	-	103N0058	117-7118	117-7120	117U7018	117U5025	-	103N1010	103N2011	
3/5	8.0	7.8	0.32	0.26	0.26	X	-	-	-	-	103N0058	117-7114	-	117U7020	117U5039	-	103N1010	-	
3/5	8.0	7.8	0.32	0.26	0.26	X	-	-	-	-	103N0058	117-7114	-	117U7020	117U5023	-	103N1010	-	
2/5	8.2	8.0	0.38	0.26	0.26	-	-	-	-	-	-	-	-	117U7020	117U5023	-	103N1004	103N2008	
3/5	8.2	8.0	0.38	0.26	0.26	X	-	-	-	-	-	-	-	117U7020	117U5023	-	103N1004	103N2008	
3/4	8.6	8.4	0.38	0.26	0.26	-	-	-	-	-	-	117-7114	-	117-7441	117U5043	117-7053	-	117U1021	
5/6	8.6	8.4																	

PL

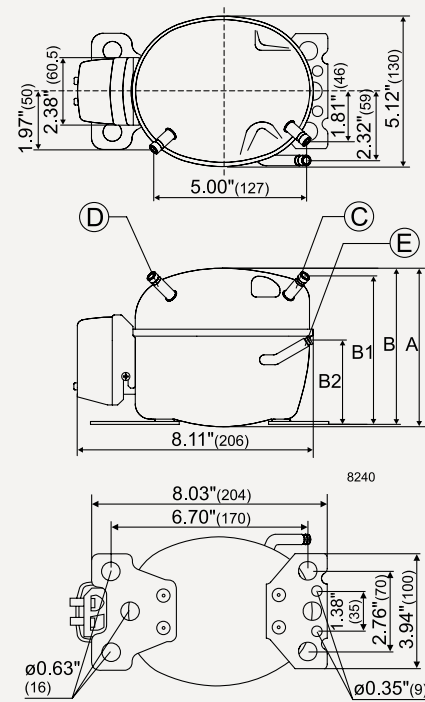

TF/TFS

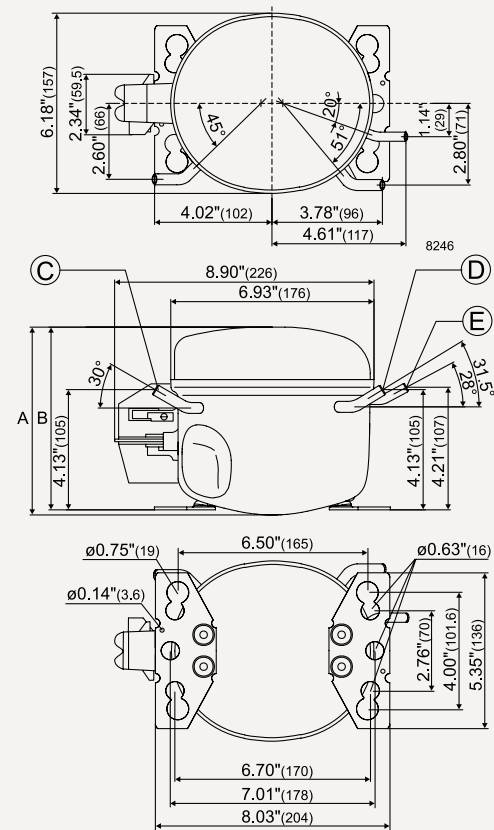

NF

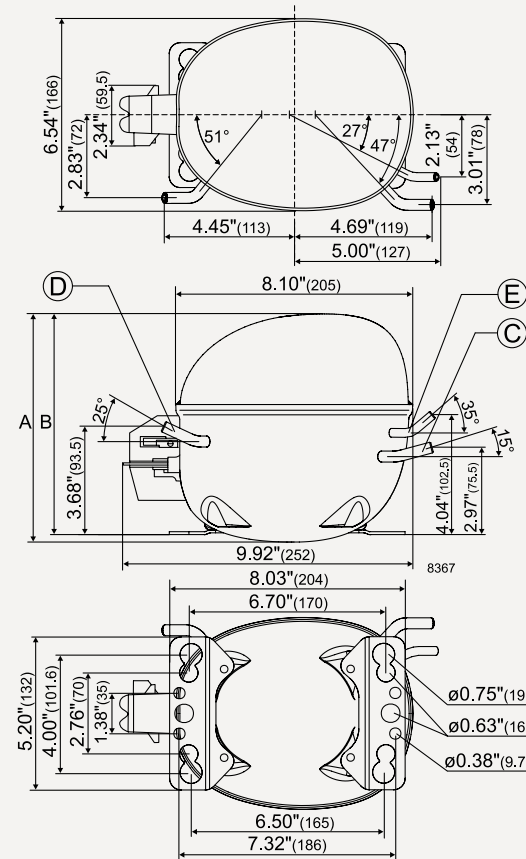

FF (FR similar)

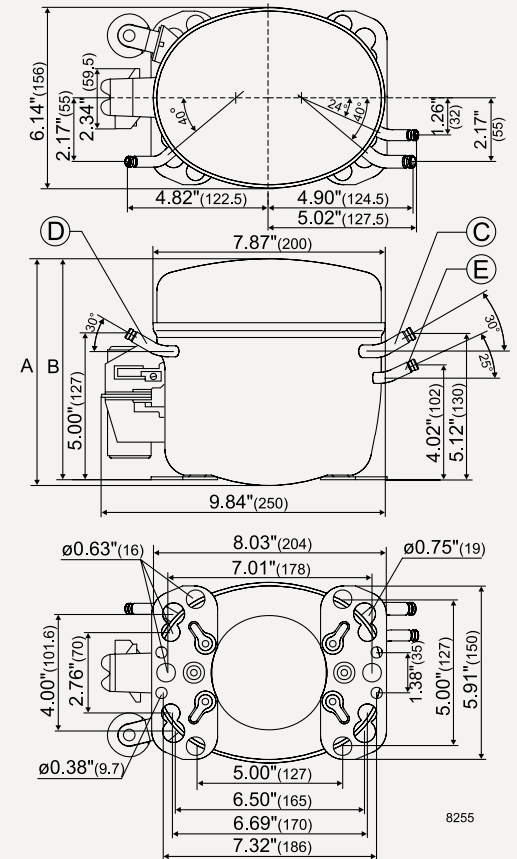

DLE (R290)

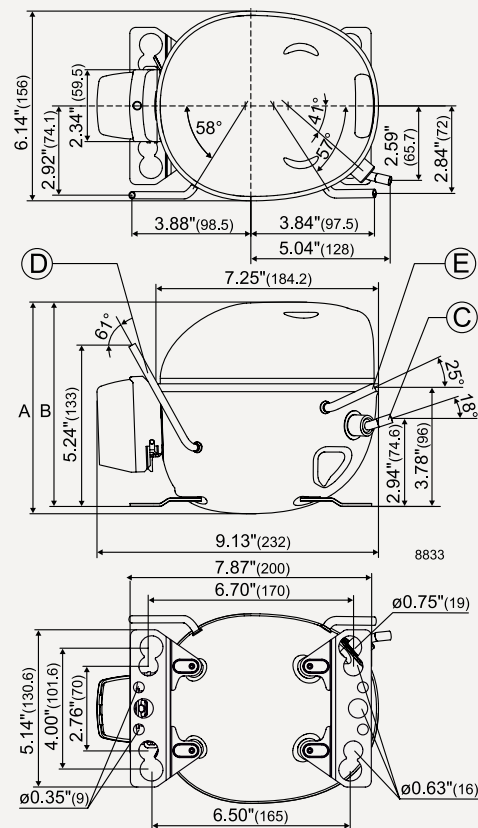

NLE (R290)

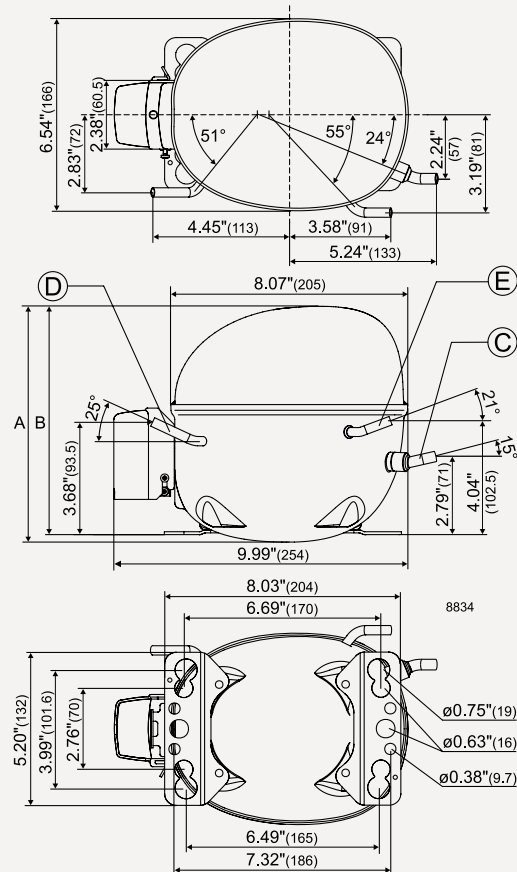

SC (external protector)

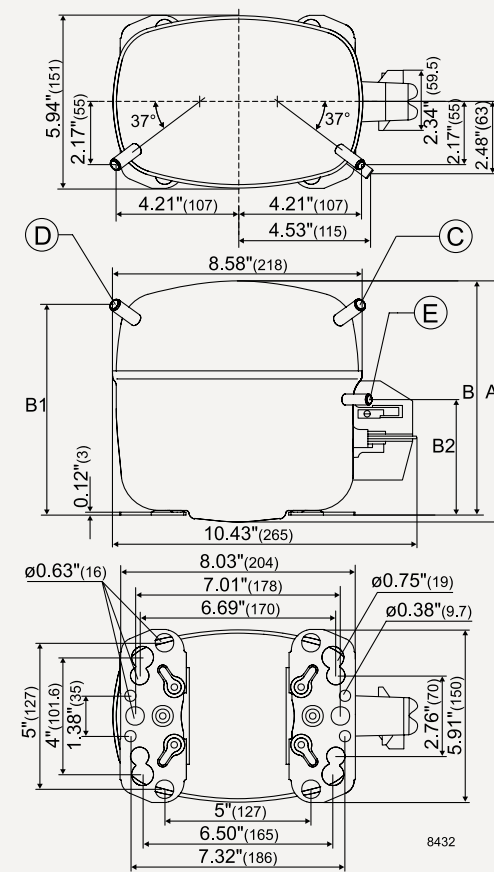

SCE (R290, external protector)

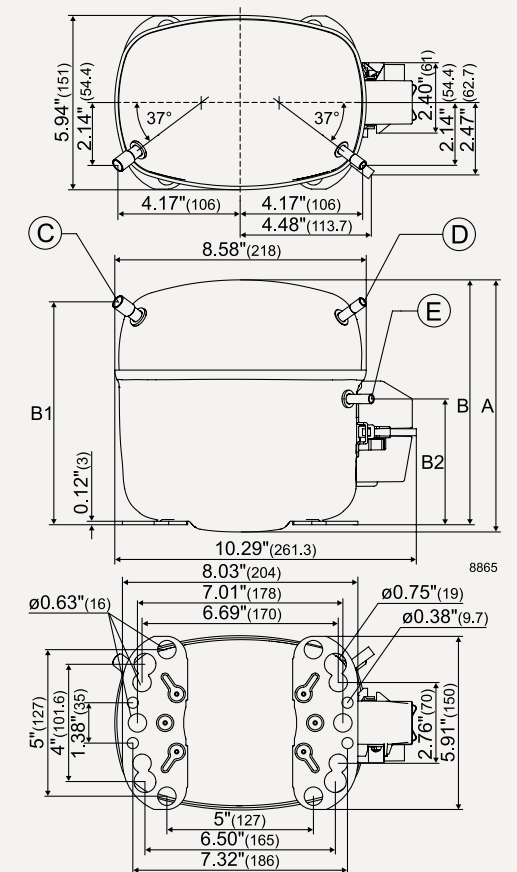

TL

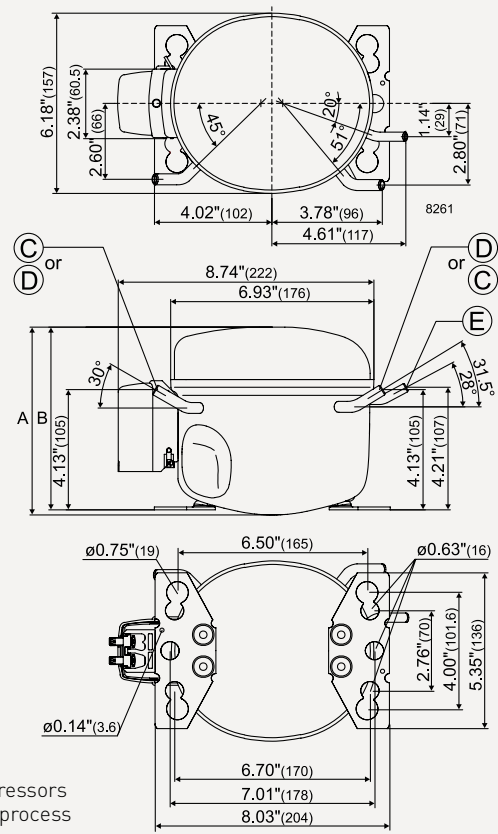

Note:
On TL compressors suction and process connectors are interchangeable.

NL (NLE similar)

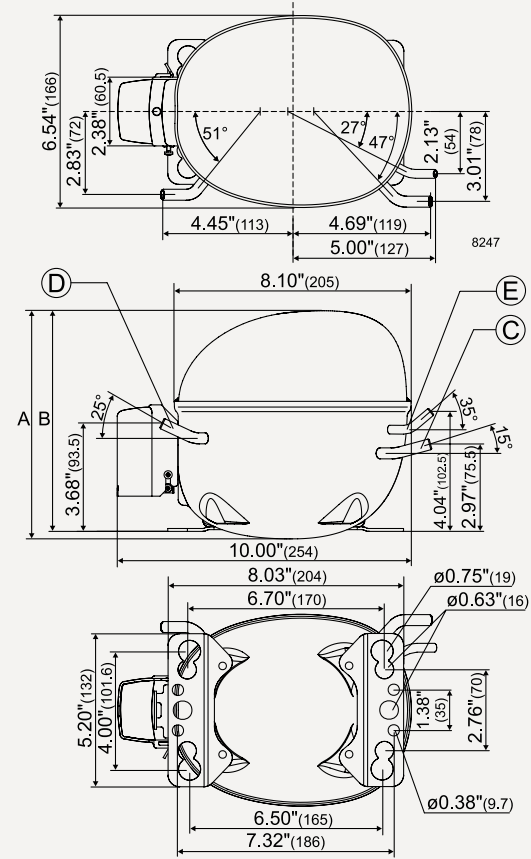

HXX (K-Series)

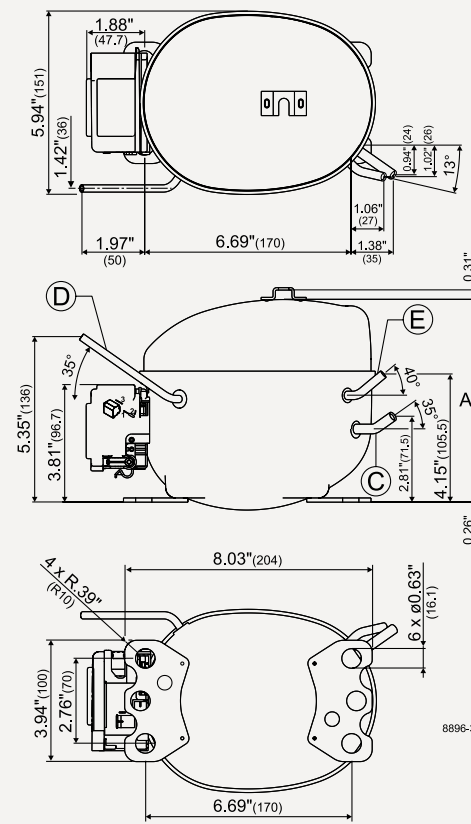

SC Twin

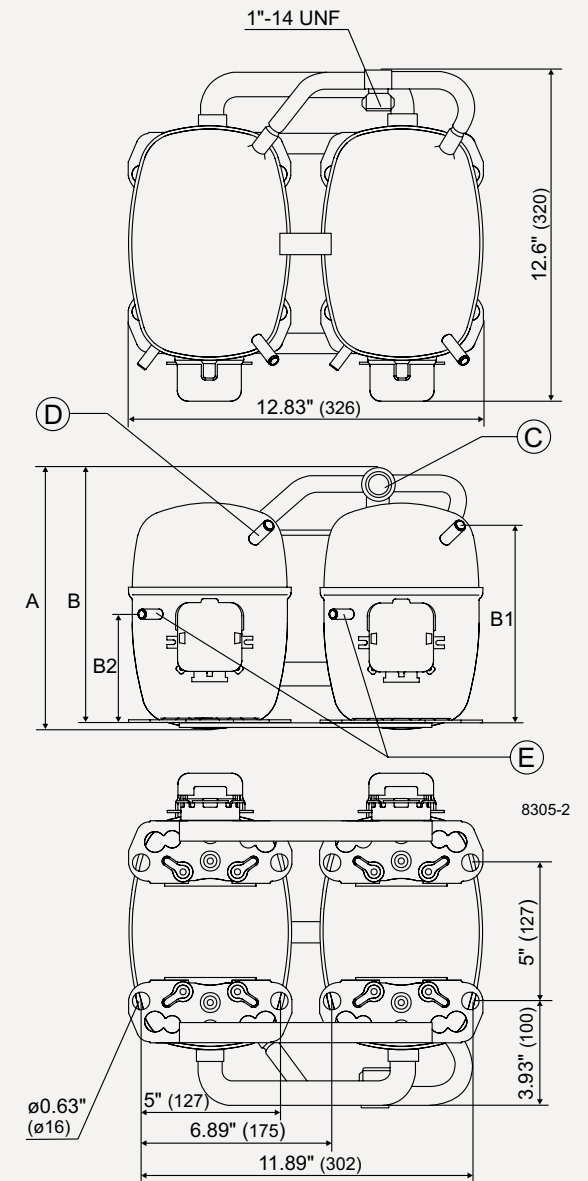

SC

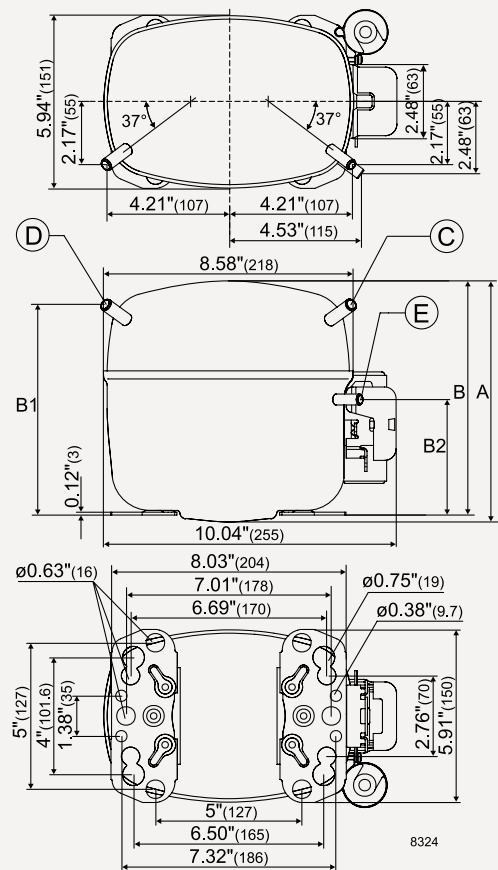

GS

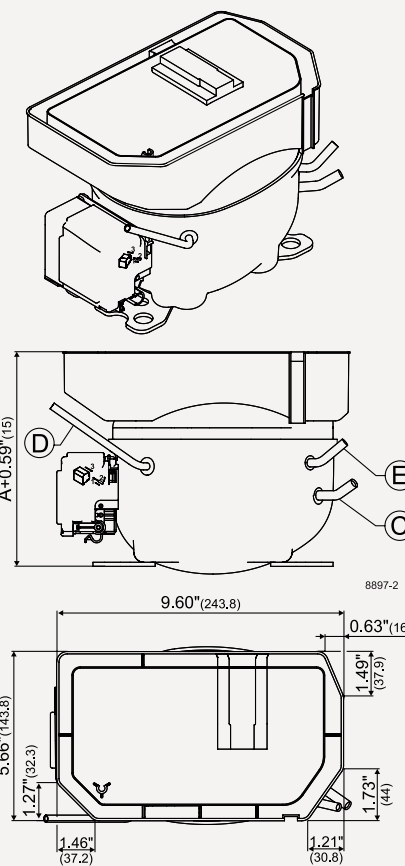
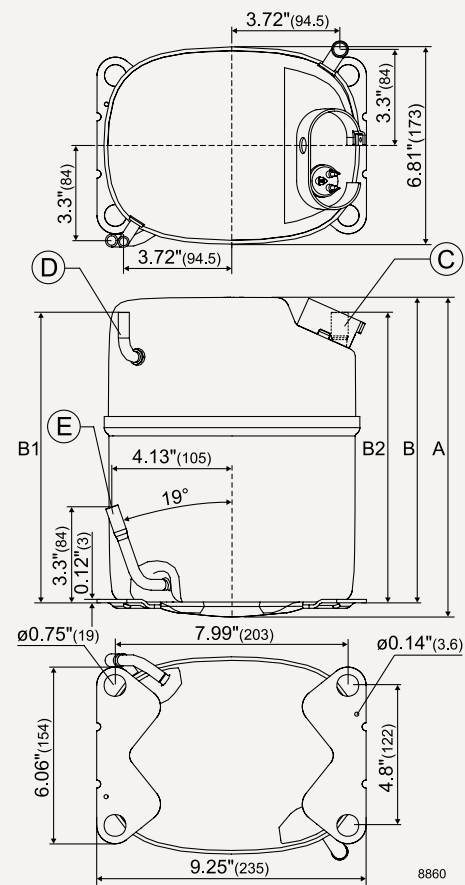

Accessories for SC Twin

SC10/10, SC12/12 and SC15/15:	
Service valve for 12 mm tube	118-7350
Solder connector for 12 mm tube	104B0584
SC18/18 and SC21/21:	
Service valve for 16mm tube	118-7351
Solder connector for 16mm tube	118-7405
SC18/18 and SC21/21:	
Seal ring for service valve and solder connector	118-3638
Time delay relay	117N0001
Check valve (to be used with time delay relay)	020-1014

LST - RSIR

PL-DLE

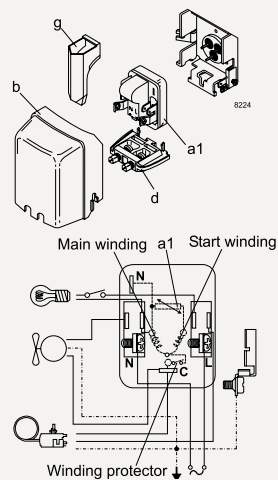

TL/TLES/TLS/TLY - NL/NLE - FR

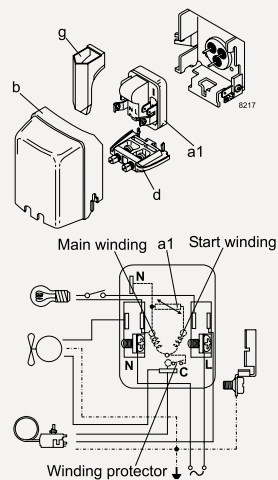

LST - RSCR

PLE - DLE/DLX/DLY

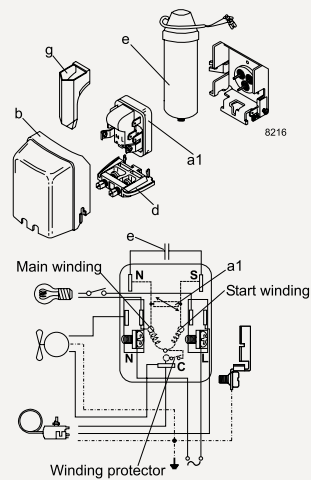

LST - RSIR

TF/TFS - NF - FF - external protector

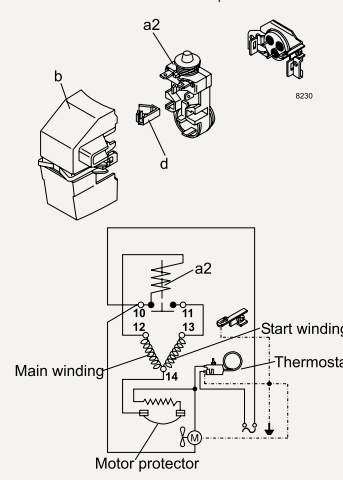

TT - external protector

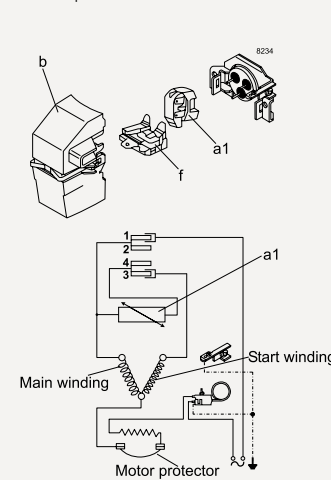

TF - NF - FF - external protector

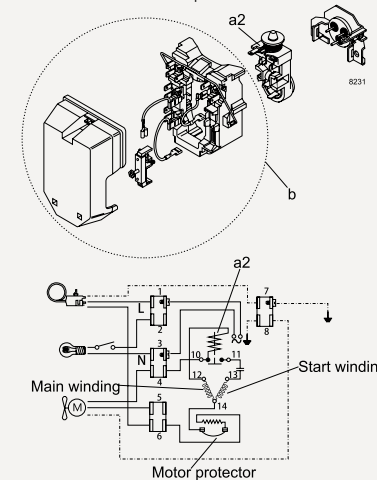

HST - CSIR

PL - DLE

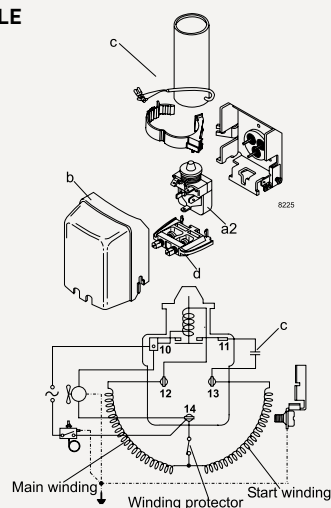

TL/TLES/TLS - NL/NLE - FR/NLE - FR

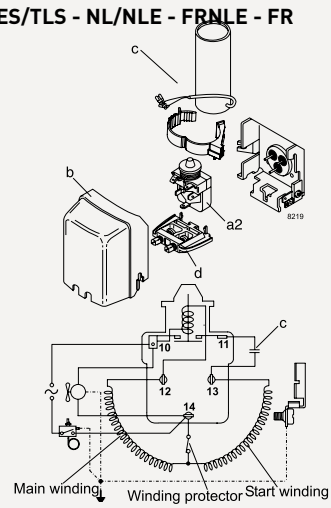

LST - RSCR

TLES/TLS/TLX/TLY - NLE/NLU/NLX/NLY

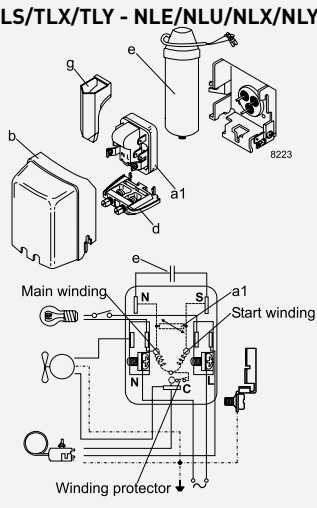

HST - CSIR

TFS - NF - FF - external protector

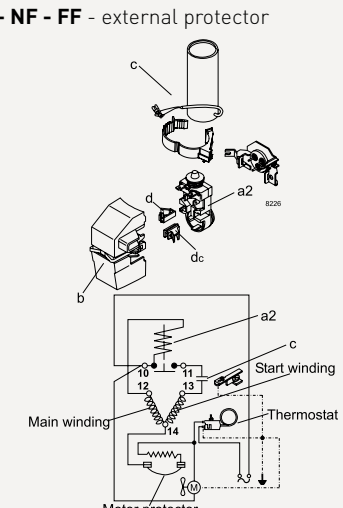

FF - external protector

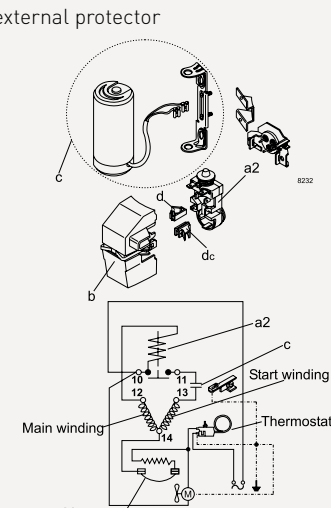

TF - NF - FF - external protector

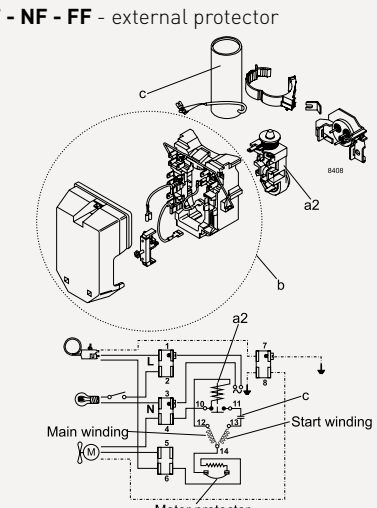

Legend

- a1: PTC or ePTC starting device
- a2: Starting relay
- a3: Starting device
- b: Cover
- b1: Clamp (part of compressor)
- b2: Gasket (part of compressor)
- c: Starting capacitor
- d: Cord relief
- e: Run capacitor
- f: Protector
- g: Protection screen for PTC
- h: Holder

PTC protection screen

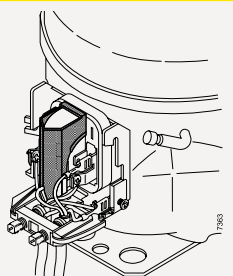

Note:
To fulfil the requirements of EN 60335-2-34 the protection screen 103N0476 must be applied to the PTC starting device.

HST - CSIR

SC Twin

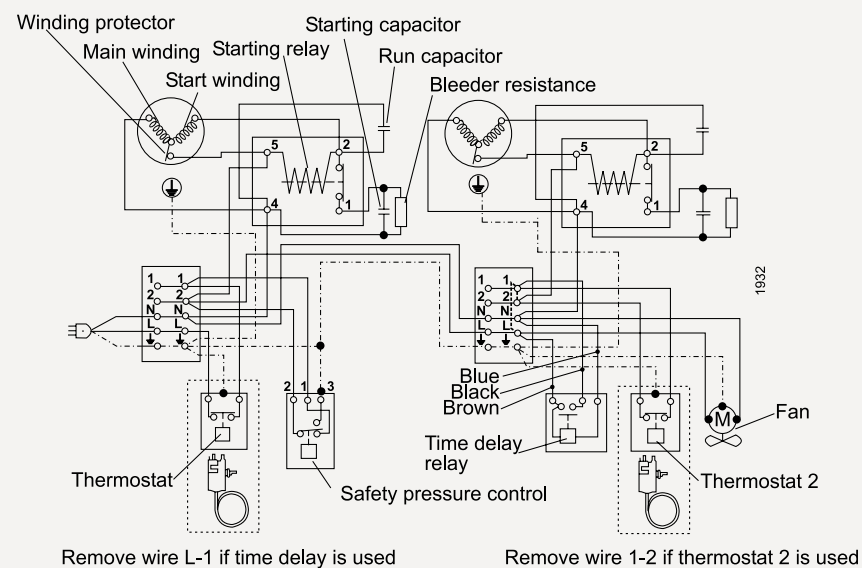

HST - CSR

SC Twin

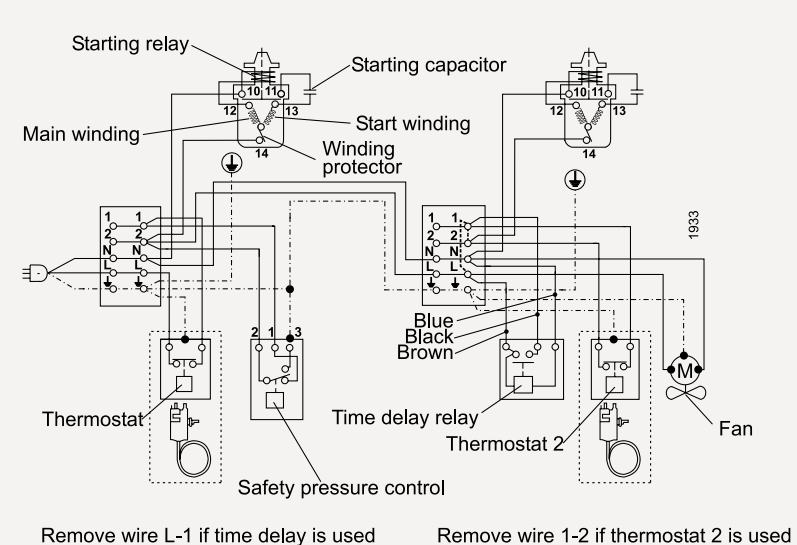

LST - RSCR

TTE/TTY - NTX/NTY - external protector

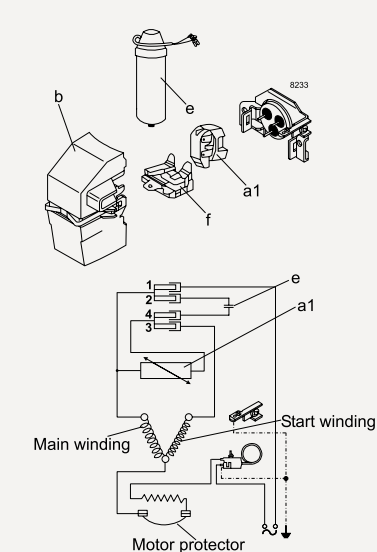

HST - CSIR

SC

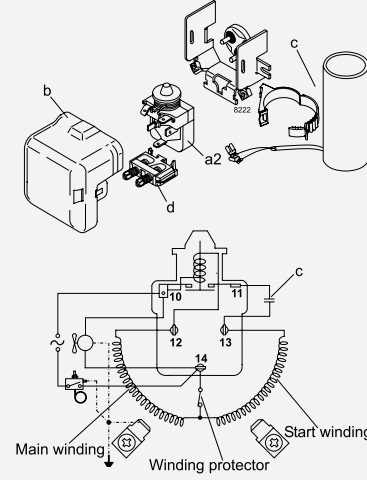

SC - external protector

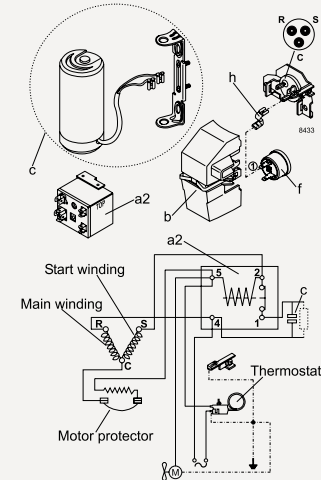

SC - external protector

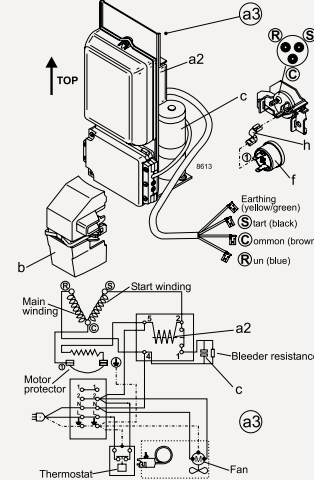

HST - CSIR

SCE - external protector

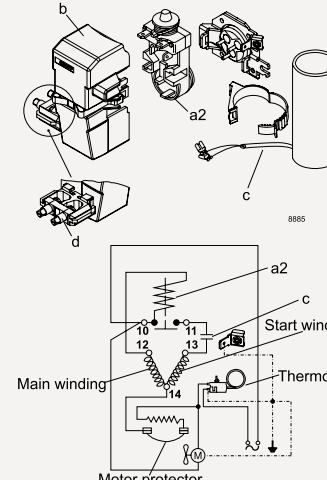

SCE - external protector

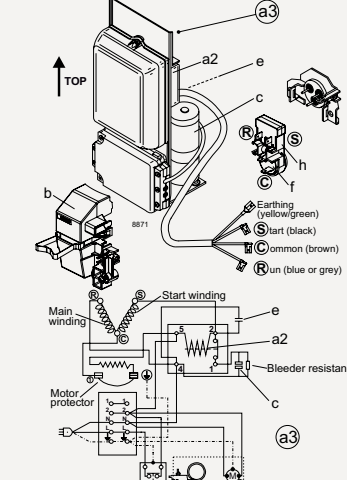

SCE - external protector

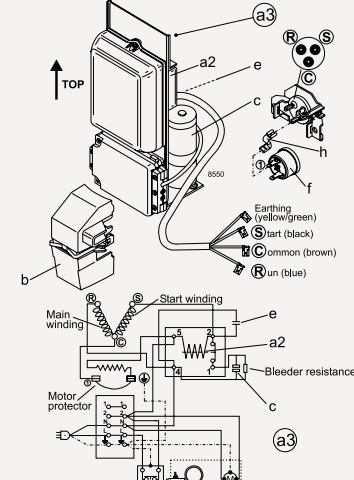

LST - RSIR

SC

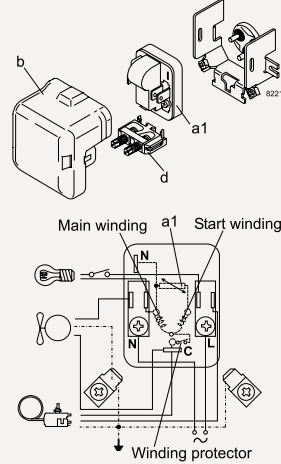

SC - external protector

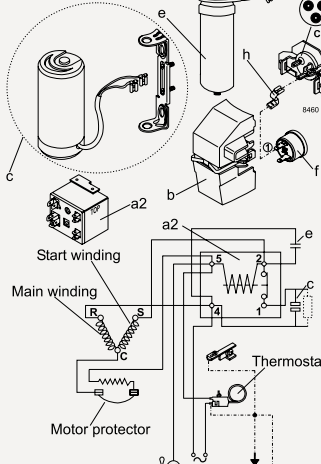

HST - CSR

SC - external protector

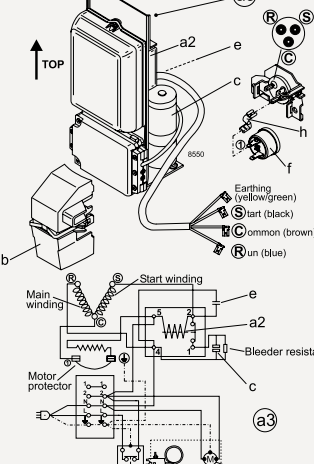

LST - RSCR

HKK/HTK/HXK/HZK - external protector, terminal board for HZK includes an ePTC

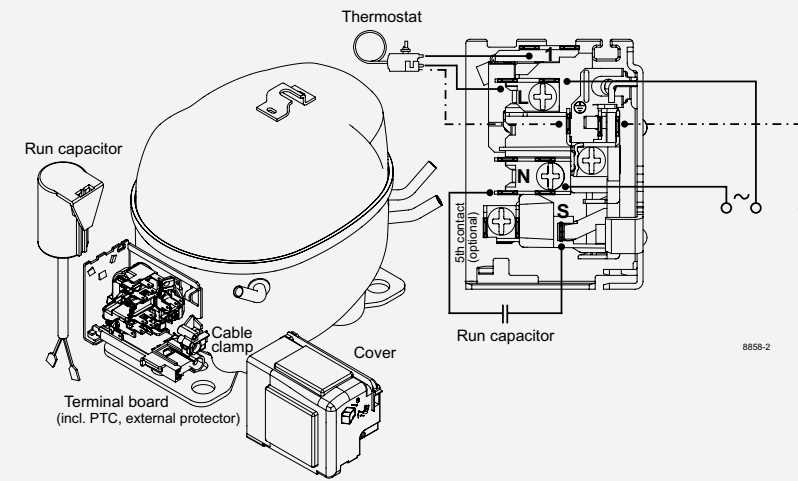

Legend

- a1: PTC or ePTC starting device
- a2: Starting relay
- a3: Starting device
- b: Cover
- b1: Clamp (part of compressor)
- b2: Gasket (part of compressor)
- c: Starting capacitor
- d: Cord relief
- e: Run capacitor
- f: Protector
- g: Protection screen for PTC
- h: Holder

HST - CSR

SC

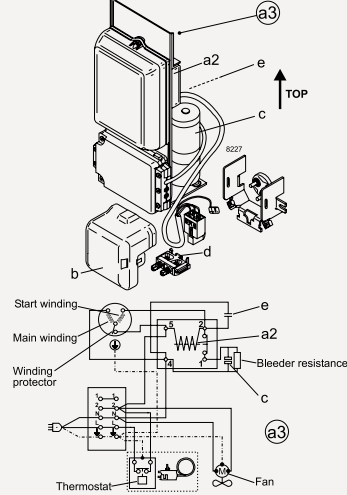

SC (kit) - alternative to starting device

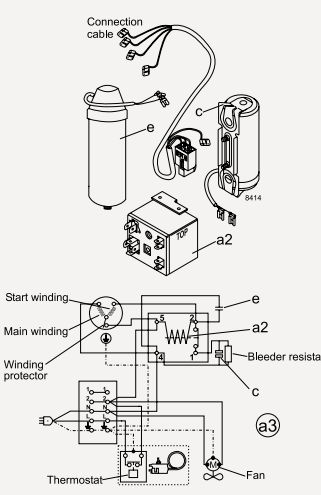

GS

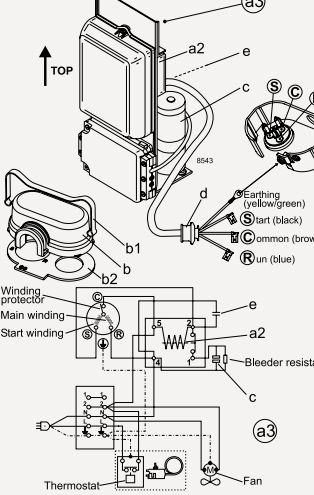

LST - RSIR

HMK/HTK/HXK-AT - external protector

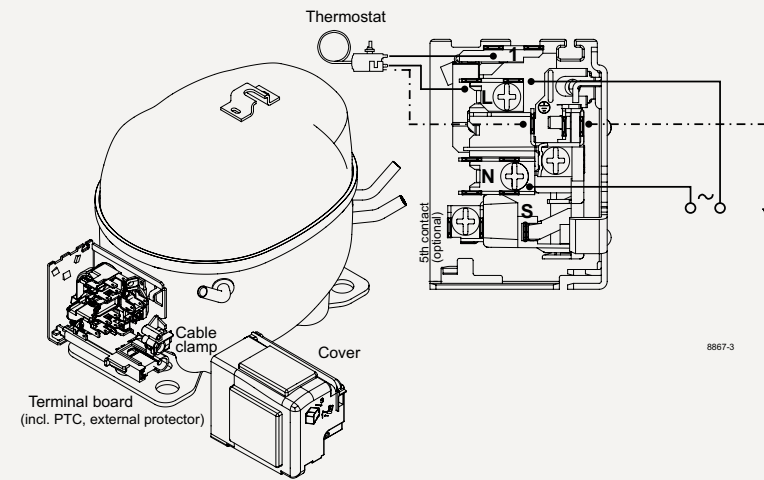

Mounting accessories

Mounting	Code number	Bolt / pin dimension	Comp. base hole	Type of packaging	Compressor series	Parts list
Bolt joint	118-1917	M6 metric	16 mm	Single pack for one compressor	P- / T- / D- / N- / F- / S-Series	I
Bolt joint	118-1918	M6 metric	16 mm	Industrial pack in any quantity	P- / T- / D- / N- / F- / S-Series	I
Bolt joint	107B9150	M8 metric	19 mm	Single pack for one compressor	G-Series	II
Bolt joint	118-1946	1/4 inch	16 mm	Single pack for one compressor	P- / T- / D- / N- / F- / S-Series	III
Bolt joint	118-1949	1/4 inch	19 mm	Single pack for one compressor	all with 19 mm base holes [except G-Series]	IV
Snap-on	118-1947	∅ 7.3 mm	16 mm	Single pack for one compressor	P- / T- / D- / N- / F- / S-Series K-Series	V
Snap-on	118-1919	∅ 7.3 mm	16 mm	Industrial pack in any quantity	P- / T- / D- / N- / F- / S-Series K-Series	V

Parts list (4 pcs. per compressor needed)		Symbol drawings
I	Sleeve ∅ 8 mm x 6.4 mm x 0.8 mm	112-2052
	Washer ∅ 20 mm x ∅ 6.7 mm x 1 mm	112-2053
	Bolt M6 x 25 mm	681X1130
	Nut M6	118-3659
	Rubber grommet 16 mm	118-3661
II	Sleeve ∅ 11 mm x 8.6 mm x 1.2 mm	107B9152
	Washer ∅ 20 mm x ∅ 8.8 mm x 1.2 mm	107B9155
	Bolt M8 x 40 mm	107B9153
	Nut M8	107B9154
	Rubber grommet 19 mm	107B9151
III	Sleeve ∅ 8.3 mm x 6.7 mm x 0.8 mm	112-2088
	Washer ∅ 20 mm x ∅ 6.7 mm x 1 mm	112-2053
	Bolt 1/4 x 1 inch, 20 UNC	119-3002
	Nut 1/4 inch, 20 UNC	119-3031
	Rubber grommet 16 mm	118-3661
IV	Sleeve ∅ 9.5 mm x 7.9 mm x 0.8 mm	112-2085
	Washer ∅ 20 mm x ∅ 6.7 mm x 1 mm	112-2053
	Bolt 1/4 x 1 1/4 inch, 20 UNC	119-3002
	Nut 1/4 inch, 20 UNC	119-3031
	Rubber grommet 19 mm	118-3666
V	Steel pin	118-3586
	Washer ∅ 21 x ∅ 8.1 mm x 0.9 mm	118-3588
	Clip	118-3585
	Rubber Grommet 16 mm	118-3661

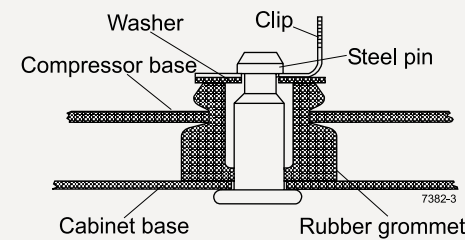
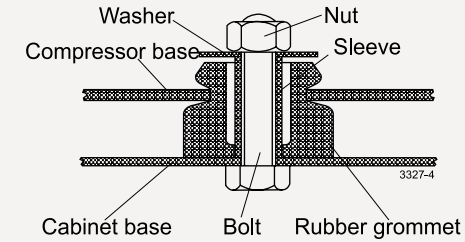

Flammable refrigerants R600a and R290



R600a (isobutane) and R290 (propane) are hydrocarbons. Hydrocarbon refrigerants are flammable and are only allowed for use in appliances that meet the requirements set out in the latest revision of EN/IEC 60335-2-34.

Do not use the refrigerants R600a or R290 near an open fire. The refrigeration systems must be opened with a tube cutter.

To properly perform maintenance and repair work on R600a or R290 systems, service staff must be properly trained in handling flammable refrigerants. This includes knowledge of tools, transportation of the compressor and refrigerant, and the relevant regulations and safety precautions when carrying out service and repair work.

Secop compressors that use flammable refrigerants R600a and R290 are equipped with a yellow warning label as shown.

Further information

Applications

LBP: Low Back Pressure
HBP: High Back Pressure
MBP: Medium Back Pressure

Motor types

RSIR: Resistant Start Induction Run
RSCR: Resistant Start Capacitor Run
CSIR: Capacitor Start Induction Run
CSR: Capacitor Start Run

Compressor cooling

S = Static cooling normally sufficient
O = Oil cooling
F1 = Fan cooling 1.5 m/s (compressor compartment temp. equal to ambient temperature)
F2 = Fan cooling 3.0 m/s necessary

Starting devices

LST: Low Starting Torque
 LST is used with capillary tube control and pressure equalizing. (Pressure equalizing may exceed 10 minutes). The PTC starting device requires 5 minutes cooling before each start.

HST: High Starting Torque
 HST consisting of relay and starting capacitor is used for expansion valve control or for capillary tube control without pressure equalizing.

ePTC: Electronically controlled PTC

- Compressor restart possible after a few seconds
- Operational wattage loss reduced by 2 watt
- PTC protection screen not needed [surface temp. < 82 °C]



SECOP GROUP: AROUND THE WORLD

SECOP

12

international
partners for
advanced
developments

33

laboratories
located in Austria,
Germany, Slovakia,
China, US, and
Turkey

180

R&D engineers
and technicians

440

patents globally

50+

countries with
customer support

WE SUPPORT









Since 2011 Secop has been committed to the UN Global Compact corporate responsibility initiative and its principles in the areas of human rights, labor, the environment and anti-corruption.



Secop is the expert for advanced hermetic compressor technologies and cooling solutions in commercial refrigeration. We develop high performance stationary and mobile cooling solutions for leading international commercial refrigeration manufacturers and are the first choice when it comes to leading hermetic compressors and electronic controls for refrigeration solutions for light commercial and DC-powered applications.

Secop has a long track record of successful projects to adopt energy efficient and green refrigerants that feature innovative solutions for both compressors and control electronics.

-  **Flensburg:** Sales and R&D
-  **Zlaté Moravce:** R&D, Logistics and Manufacturing
-  **Turin:** Sales
-  **Tianjin:** Sales, R&D, Logistics and Manufacturing
-  **Gleisdorf:** R&D
-  **Atlanta:** Sales, R&D and Logistics



**MOBILE
COOLING**



**STATIONARY
COOLING**



Secop GmbH · Mads-Clausen-Str. 7 · 24939 Flensburg, Germany · Tel: +49 461 4941 0 · www.secop.com

Secop accepts no responsibility for possible errors in catalogs, brochures, and other printed material. Secop reserves the right to alter its products without notice. This also applies to products already on order provided that such alterations can be made without subsequent changes being necessary to specifications already agreed. All trademarks in this material are the property of the respective companies. Secop and the Secop logotype are trademarks of Secop GmbH. All rights reserved.