

HXK87AA KAPPA LBP Compressor Superior Efficiency R600a 220-240V 50Hz

General

Code number	CDO00103
Approvals	EN 60335-2-34 w. Annex AA
Compressors on pallet	100

Application

Application	LBP		
Frequency	Hz	50	60
Evaporating temperature	°C	-35 to -5	—
Voltage range	V	187 to 264	—
Max. condensing temperature continuous (short)	°C	60 (70)	—
Max. winding temperature continuous (short)	°C	130 (130)	—

Cooling requirements

Frequency	Hz	50			60		
Application		LBP	MBP	HBP	LBP	MBP	HBP
32°C		S	—	—	—	—	—
38°C		S	—	—	—	—	—
43°C		S	—	—	—	—	—
Remarks on application:							

Motor

Motor type	RSCR		
LRA (rated after 4 sec. UL984), HST LST	A	—	3.8
Cut in Current, HST LST	A	—	11.6
Resistance, main start winding (25°C)	Ω	22.8	15.60

Design

Displacement	cm ³	8.8
Oil quantity (type)	cm ³	165 (mineral)
Maximum refrigerant charge	g	150
Free gas volume in compressor	cm ³	1560
Weight without electrical equipment	kg	8.6

Dimensions

Height	mm	A	167.0
		B	173.5
Suction connector	location/I.D. mm angle	C	6.15 35°
	material comment		Copper Rubber plug
Process connector	location/O.D. mm angle	D	6.00 35°
	material comment		Copper Rubber plug
Discharge connector	location/I.D. mm angle	E	5.15 40°
	material comment		Copper Rubber plug
Oil cooler connector	location/I.D. mm angle	F	—
	material comment		—
Connector tolerance	I.D. mm		±0.05
Remarks:			

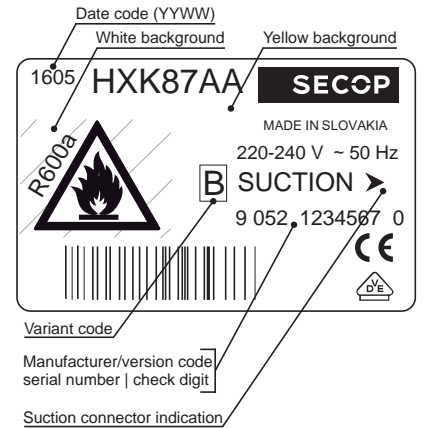

- S = Static cooling normally sufficient
- O = Oil cooling
- F₁ = Fan cooling 1.5 m/s (compressor compartment temperature equal to ambient temperature)
- F₂ = Fan cooling 3.0 m/s necessary
- SG = Suction gas cooling normally sufficient
- = not applicable in this area

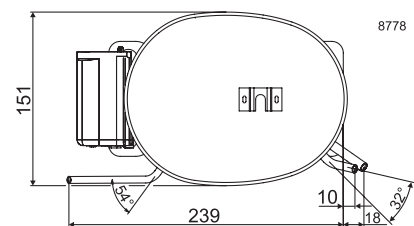
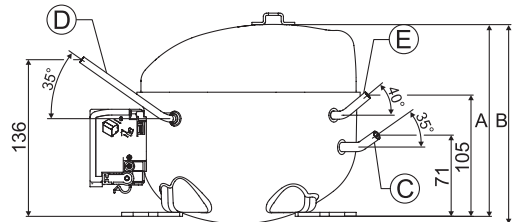
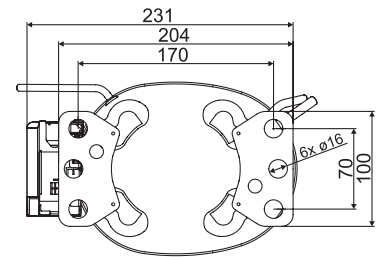

220V, 50Hz, RC 4 μ F, ePTC consumption incl., static cooling (alternative use of PTC +2W)

ASHRAE LBP

220V, 50Hz, RC 4μF, ePTC consumption incl., static cooling (alternative use of PTC +2W)

This diagram illustrates the exploded view of the RSCR control unit assembly. The components shown include the **Run capacitor**, the **Terminal board (incl. ePTC, external protector)**, a **Cable clamp**, the **Cover**, and the **Thermostat**. The diagram shows how these parts are positioned relative to each other for assembly.

Outline dimensions with plastic evaporation tray

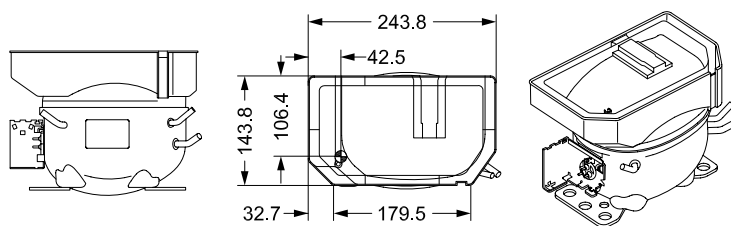
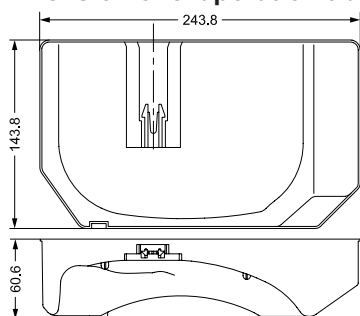

Test conditions	EN 12900 Household	ASHRAE LBP
Condensing temperature	55°C	54.4°C
Ambient temperature	32°C	32.2°C
Suction gas temperature	32°C	32.2°C
Liquid temperature	no subcooling	32.2°C

Mounting accessories	Code number
on request, various options available	

2/2