

Model

Designation **CU SC15MLX MG_Z 230/1/50 CAP**



Sales code: 314L4012
Engineering code: CUSC15MLX00CE

Application Data

Power supply 220-240V / 50Hz 1~
Refrigerants R404A-R452A-R449A
Refr. charge - tech. limit 1300g / 45,9oz
Starter HST / capillary tube or expansion valve
Sound pressure (10m) 36,1dB(A)

Configuration data

	Conf. 1	Conf. 2	Conf. 3
Voltage range	198 - 254V / 50Hz	198 - 254V / 50Hz	198 - 254V / 50Hz
Refrigerant	R404A	R452A	R449A
Application	MBP	MBP	MBP
Rated performance	<u>pe=-10°C, Tsuc=20°C, Tamb=25°C, subccoling: 2K</u>		
Cooling capacity	1352W / 4619Btu/h	1289W / 4403Btu/h	1247W / 4260Btu/h
Power consumption	784,5W	744,6W	698,7W
Current consumption	4,8A	4,6A	4,4A
COP/EER	1,72 / 5,89Btu/Wh	1,73 / 5,91Btu/Wh	1,79 / 6,1Btu/Wh
Approvals	CE, UK CA, VDE	CE, UK CA, VDE	CE

Compressor

Designation **SC15MLX**
Motor configuration CSIR
Locked rotor amperage 23,5A
Rated load amperage 4,5A
Winding resistance main 3,3Ω
Winding resistance aux 16,5Ω
Oil quantity 550cm³ / 18,6fl.oz
Oil type POE
Horsepower rating 3/4 HP

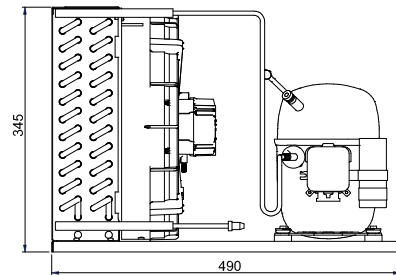

Dimensions

Condensing unit

Height x Width x Depth 345 x 390 x 490 [mm] / 13,6 x 15,4 x 19,3 [in]
Weight 21,5kg / 47,3lbs
Suction adapter OD ø10mm / 2/5in
Discharge adapter OD ø6mm / 1/4in
Process connector ø6,2mm / 0,24in

Package data

Height x Width x Depth 400 x 500 x 600 [mm] / 15,7 x 19,7 x 23,6 [in]
Weight 25,5kg / 56,1lbs

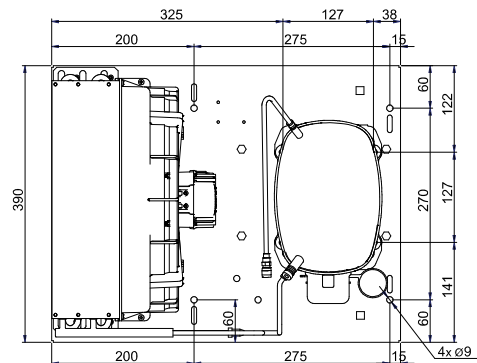

Model

Designation **CU SC15MLX MG_Z 230/1/50 CAP**

Sales code: 314L4012

Engineering code: CUSC15MLX00CE

Components Condensing-Unit / Spare Parts

Component	Type	Spare part code number
Compressor code	SC15MLX	104L2869
Condenser	Condenser (4 rows x 13 tubes)	1340315F70
Fan motor		62010155
Blade code	ø300mm 19°	A300-19
Air flow	914,3m³/h	
Receiver code	not installed	-/-
Suction valve code	OD ø10mm / 2/5in	-/-
Liquid valve code	OD ø6mm / 1/4in	-/-

Compressor starting equipment	Spare part code number
pos. a2 - relay	117U6013
pos. c - start capacitor (125µF)	117U5012
pos. d - cord relief	103N1004
pos. b - plastic cover	103N2009

Wiring Sketch Compressor

Wiring Sketch Condensing Unit

CSIR

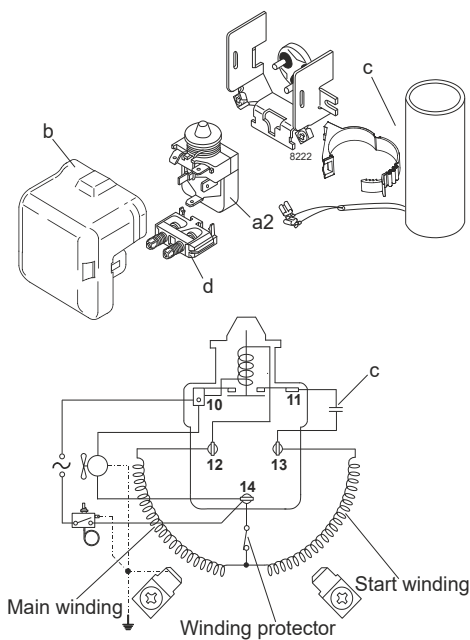

Model

Designation **CU SC15MLX MG_Z 230/1/50 CAP**

Sales code: 314L4012

Engineering code: CUSC15MLX00CE

Cooling performance - Conf. 1

Power supply	220-240V / 50Hz 1~	Voltage range	198 - 254V / 50Hz
Refr. charge - tech. limit	1300g / 45,9oz		
Starter	HST / capillary tube or expansion valve		
Motor configuration	CSIR		
Refrigerant	R404A		
Application	MBP		
Approvals	CE, UK CA, VDE		

ambient temperature	[°C / °F]	25 / 77				(suction gas temperature [°C / °F]: 20 / 68, subcooling: 2K)			
evaporating temperature	[°C / °F]	-25 / -13	-20 / -4	-15 / 5	-10 / 14	0 / 32	5 / 41	10 / 50	
cooling capacity	[W]	778	947	1139	1352	1830	2087	2349	
COP	[W/W]	1,28	1,43	1,58	1,72	1,96	2,05	2,1	
cooling capacity	[Btu/h]	2655	3233	3890	4618	6250	7128	8022	
power consumption	[W]	608	663	721	785	932	1019	1117	
current consumption	[A]	4	4,2	4,5	4,8	5,4	5,9	6,3	

ambient temperature	[°C / °F]	32 / 90				(suction gas temperature [°C / °F]: 20 / 68, subcooling: 2K)			
evaporating temperature	CE, / °F]	-25 / -13	-20 / -4	-15 / 5	-10 / 14	CE	5 / 41		
cooling capacity	[W]	683	835	1006	1196	1618	1843		
COP	[W/W]	1,12	1,25	1,37	1,48	1,66	1,72		
cooling capacity	[Btu/h]	2332	2851	3437	4085	5524	6293		
power consumption	[W]	608	670	736	808	974	1072		
current consumption	[A]	4	4,3	4,5	4,9	5,6	6,1		

ambient temperature	[°C / °F]	38 / 100				(suction gas temperature [°C / °F]: 20 / 68, subcooling: 2K)			
evaporating temperature	[°C / °F]	-25 / -13	-20 / -4	-15 / 5	-10 / 14				
cooling capacity	[W]	605	740	892	1060				
COP	[W/W]	0,98	1,08	1,18	1,26				
cooling capacity	[Btu/h]	2065	2529	3048	3620				
power consumption	[W]	615	684	758	838				
current consumption	[A]	4	4,3	4,6	5				

ambient temperature	[°C / °F]	43 / 109			(suction gas temperature [°C / °F]: 20 / 68, subcooling: 2K)			
evaporating temperature	[°C / °F]	-25 / -13	-20 / -4	-15 / 5				
cooling capacity	[W]	543	663	798				
COP	[W/W]	0,87	0,95	1,02				
cooling capacity	[Btu/h]	1854	2265	2725				
power consumption	[W]	624	701	783				
current consumption	[A]	4,1	4,4	4,7				

Model

Designation **CU SC15MLX MG_Z 230/1/50 CAP**

Sales code: 314L4012

Engineering code: CUSC15MLX00CE

Cooling performance - Conf. 2

Power supply 220-240V / 50Hz 1~ Voltage range 198 - 254V / 50Hz

Refr. charge - tech. limit 1300g / 45,9oz

Starter HST / capillary tube or expansion valve

Motor configuration CSIR

Refrigerant R452A

Application MBP

Approvals CE, UK CA, VDE

ambient temperature	[°C / °F]	25 / 77				(suction gas temperature [°C / °F]: 20 / 68, subcooling: 2K)			
evaporating temperature	[°C / °F]	-25 / -13	-20 / -4	-15 / 5	-10 / 14	0 / 32	5 / 41	10 / 50	
cooling capacity	[W]	725	890	1078	1289	1768	2029	2298	
COP	[W/W]	1,27	1,43	1,58	1,73	1,98	2,07	2,13	
cooling capacity	[Btu/h]	2476	3039	3683	4404	6039	6929	7847	
power consumption	[W]	570	624	682	745	892	980	1079	
current consumption	[A]	3,8	4,1	4,3	4,6	5,2	5,6	6	

ambient temperature	[°C / °F]	32 / 90				(suction gas temperature [°C / °F]: 20 / 68, subcooling: 2K)			
evaporating temperature	CE, / °F]	-25 / -13	-20 / -4	-15 / 5	-10 / 14	CE	5 / 41		
cooling capacity	[W]	636	786	955	1144	1570	1800		
COP	[W/W]	1,12	1,25	1,37	1,49	1,68	1,75		
cooling capacity	[Btu/h]	2174	2683	3262	3907	5361	6147		
power consumption	[W]	569	630	695	766	932	1031		
current consumption	[A]	3,8	4,1	4,4	4,7	5,4	5,8		

ambient temperature	[°C / °F]	38 / 100				(suction gas temperature [°C / °F]: 20 / 68, subcooling: 2K)			
evaporating temperature	[°C / °F]	-25 / -13	-20 / -4	-15 / 5	-10 / 14				
cooling capacity	[W]	564	698	850	1018				
COP	[W/W]	0,98	1,09	1,19	1,28				
cooling capacity	[Btu/h]	1927	2384	2901	3475				
power consumption	[W]	573	641	714	794				
current consumption	[A]	3,8	4,1	4,4	4,8				

ambient temperature	[°C / °F]	43 / 109			(suction gas temperature [°C / °F]: 20 / 68, subcooling: 2K)			
evaporating temperature	[°C / °F]	-25 / -13	-20 / -4	-15 / 5				
cooling capacity	[W]	507	627	761				
COP	[W/W]	0,87	0,96	1,03				
cooling capacity	[Btu/h]	1732	2140	2600				
power consumption	[W]	581	656	736				
current consumption	[A]	3,9	4,2	4,5				

Model

Designation **CU SC15MLX MG_Z 230/1/50 CAP**

Sales code: 314L4012

Engineering code: CUSC15MLX00CE

Cooling performance - Conf. 3

Power supply 220-240V / 50Hz 1~ Voltage range 198 - 254V / 50Hz

Refr. charge - tech. limit 1300g / 45,9oz

Starter HST / capillary tube or expansion valve

Motor configuration CSIR

Refrigerant R449A

Application MBP

Approvals CE

ambient temperature	[°C / °F]	25 / 77							(suction gas temperature [°C / °F]: 20 / 68, subcooling: 2K)
evaporating temperature	[°C / °F]	-15 / 5	-10 / 14	-6,7 / 20	-5 / 23	0 / 32	5 / 41	10 / 50	
cooling capacity	[W]	1032	1247	1403	1488	1751	2033	2331	
COP	[W/W]	1,62	1,78	1,89	1,95	2,08	2,2	2,28	
cooling capacity	[Btu/h]	3524	4260	4792	5081	5979	6943	7960	
power consumption	[W]	638	699	742	765	840	925	1022	
current consumption	[A]	4,1	4,4	4,6	4,7	5	5,4	5,8	

ambient temperature	[°C / °F]	32 / 90							(suction gas temperature [°C / °F]: 20 / 68, subcooling: 2K)
evaporating temperature	CE, / °F]	-15 / 5	-10 / 14	-6,7 / 20	-5 / 23	CE	5 / 41		
cooling capacity	[W]	924	1120	1261	1338	1576	1832		
COP	[W/W]	1,42	1,56	1,64	1,69	1,79	1,88		
cooling capacity	[Btu/h]	3155	3825	4308	4569	5383	6258		
power consumption	[W]	649	718	767	793	878	974		
current consumption	[A]	4,2	4,5	4,7	4,8	5,2	5,6		

ambient temperature	[°C / °F]	38 / 100				(suction gas temperature [°C / °F]: 20 / 68, subcooling: 2K)
evaporating temperature	[°C / °F]	-15 / 5	-10 / 14	-6,7 / 20	-5 / 23	
cooling capacity	[W]	831	1010	1138	1208	
COP	[W/W]	1,25	1,36	1,43	1,46	
cooling capacity	[Btu/h]	2838	3448	3888	4124	
power consumption	[W]	667	743	797	827	
current consumption	[A]	4,2	4,6	4,8	4,9	

ambient temperature	[°C / °F]	43 / 109		(suction gas temperature [°C / °F]: 20 / 68, subcooling: 2K)
evaporating temperature	[°C / °F]	-15 / 5		
cooling capacity	[W]	755		
COP	[W/W]	1,1		
cooling capacity	[Btu/h]	2578		
power consumption	[W]	686		
current consumption	[A]	4,3		