

Brazing on Suction Connectors (SCE Compressors with Direct Suction Intake)

The new range of Secop SCE compressors features a telescope inside the compressor on the suction tube to optimize energy. This telescope is made of rubber and sensitive to exposure to high heat shell (see figure 2).

The telescope makes it no longer possible to select the process connector as the suction connector. You must choose the correct connector for the suction line (see figure 1). Please refer to the corresponding data sheet.

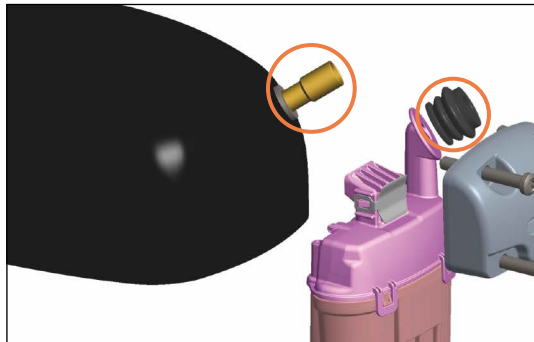
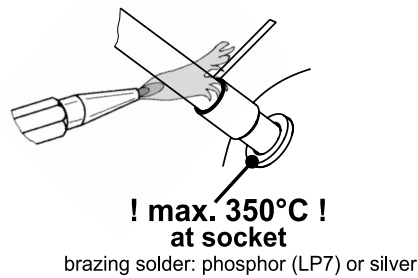

Fig.2 Suction connector and internal telescope pipe

Make sure when brazing a tube into the suction connector that the area with the telescope never exceeds 350 °C.



Use a fork burner (see figure 4) and/or a damp cloth, if necessary. A protective plate can also serve to protect the telescope from direct heat from a flame. Do not braze longer than 30 seconds.

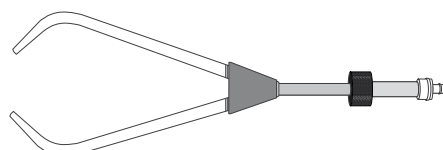

Fig.4 Fork burner



Fig.1 Suction connector (copper) on a SCE compressor

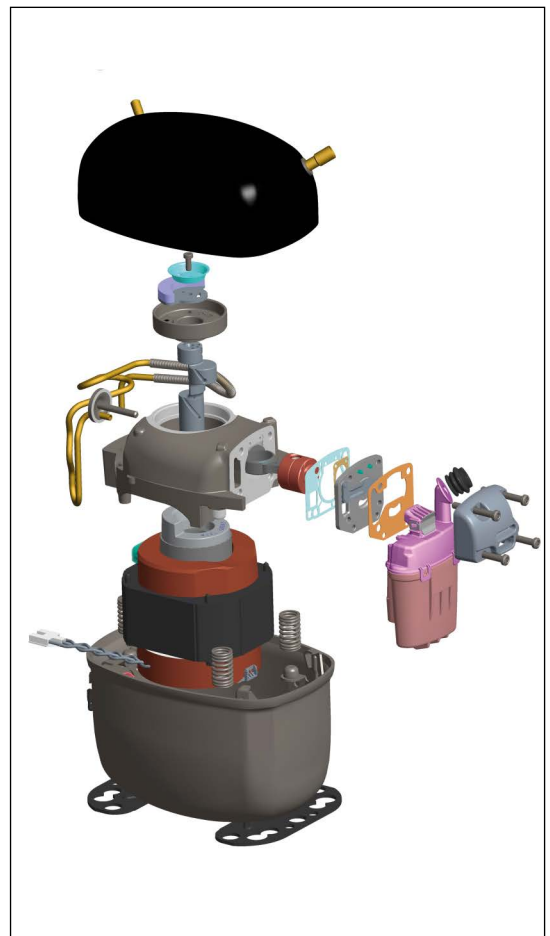

Fig.3 SCE compressor with direct suction intake