

## Cable Clamp Optimization for K-Series

Currently, Secop uses two types of cable clamps for the K-Series. The older models (also known as KAPPA) use a white cable clamp (code number 11341000, see Figure 2), which meets the V2 safety class standard.

In contrast, the new KL-Series, launched in 2023, uses a black cable clamp (code number 16058100, see Figure 3), which complies with the higher V0 safety class. Both versions share the same design and dimensions.

## Approvals

To standardize the accessory components of the K-Series and optimize the supply chain, Secop has decided to unify the cable clamp across all K-Series models by using the black cable clamp currently employed in the KL-Series.

This change will have no impact on dimensions, performance, or approvals.

## Timing and Availability

Starting in September 2025, Secop will standardize the cable clamp in all K-Series deliveries to code number 16058100.

## Further Information

For further information, please contact your local Secop representative if you have any questions.

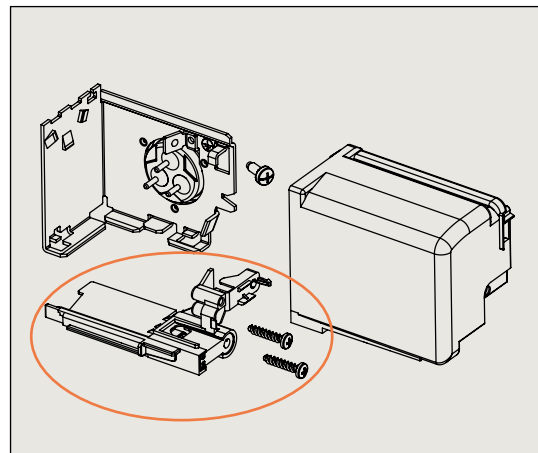

**Fig. 1** K-Series' cable clamp mounting position



**Fig. 2** K-Series cable clamp 11341000, white



**Fig. 3** K-Series cable clamp 16058100, black

## Secop GmbH

Lise-Meitner-Straße 29  
24941 Flensburg  
Germany  
Tel: +49 461 4941 0  
[www.secop.com](http://www.secop.com)

Secop accepts no responsibility for possible errors in catalogs, brochures, and other printed material. Secop reserves the right to alter its products without notice. This also applies to products already on order provided that such alterations can be made without subsequent changes being necessary to specifications already agreed. All trademarks in this material are the property of the respective companies. Secop and the Secop logotype are trademarks of Secop GmbH. All rights reserved.