

# Instructions

NLV Compressors  
100-240V 50/60Hz  
105N4962  
Controllers

**SECCP**

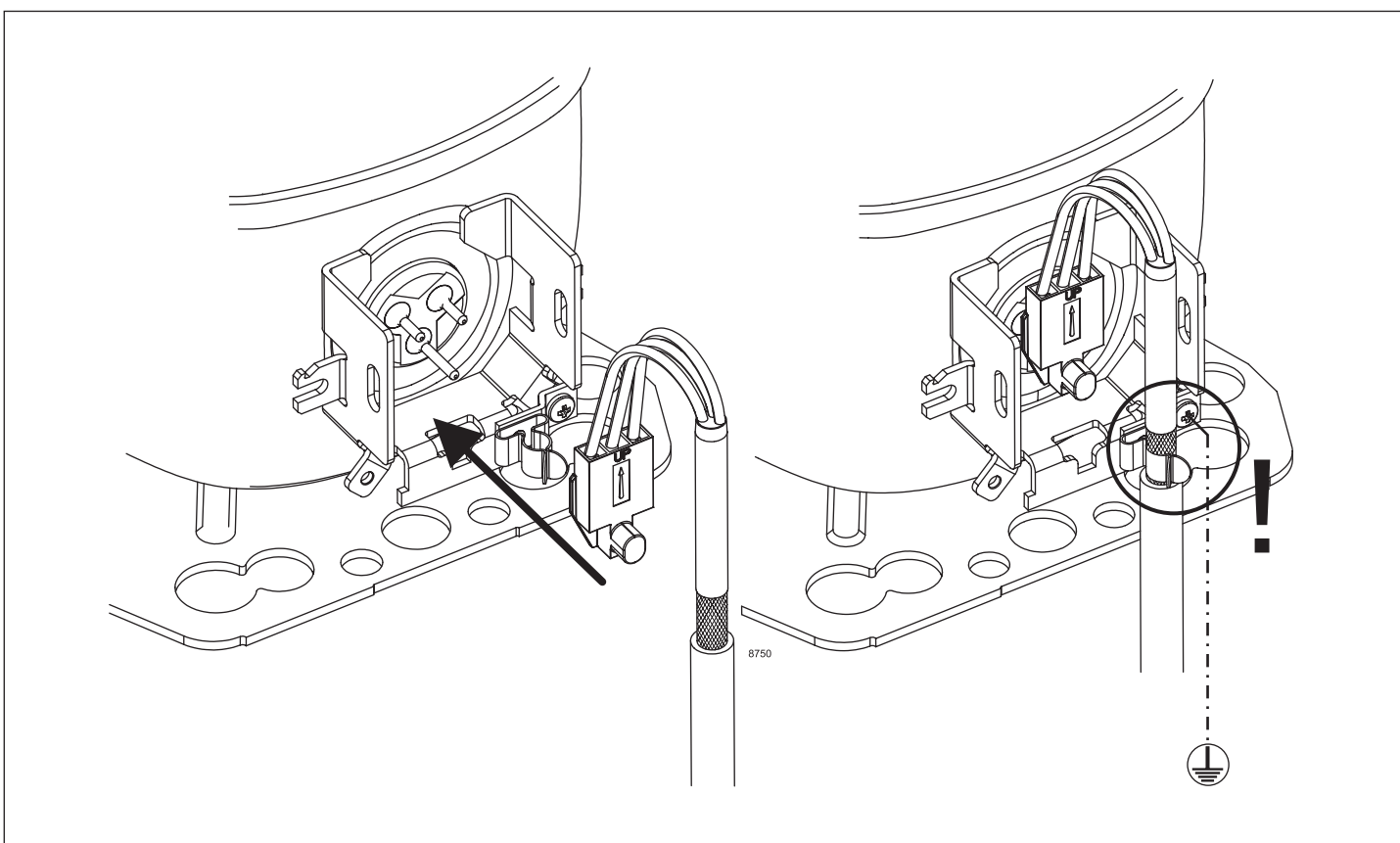

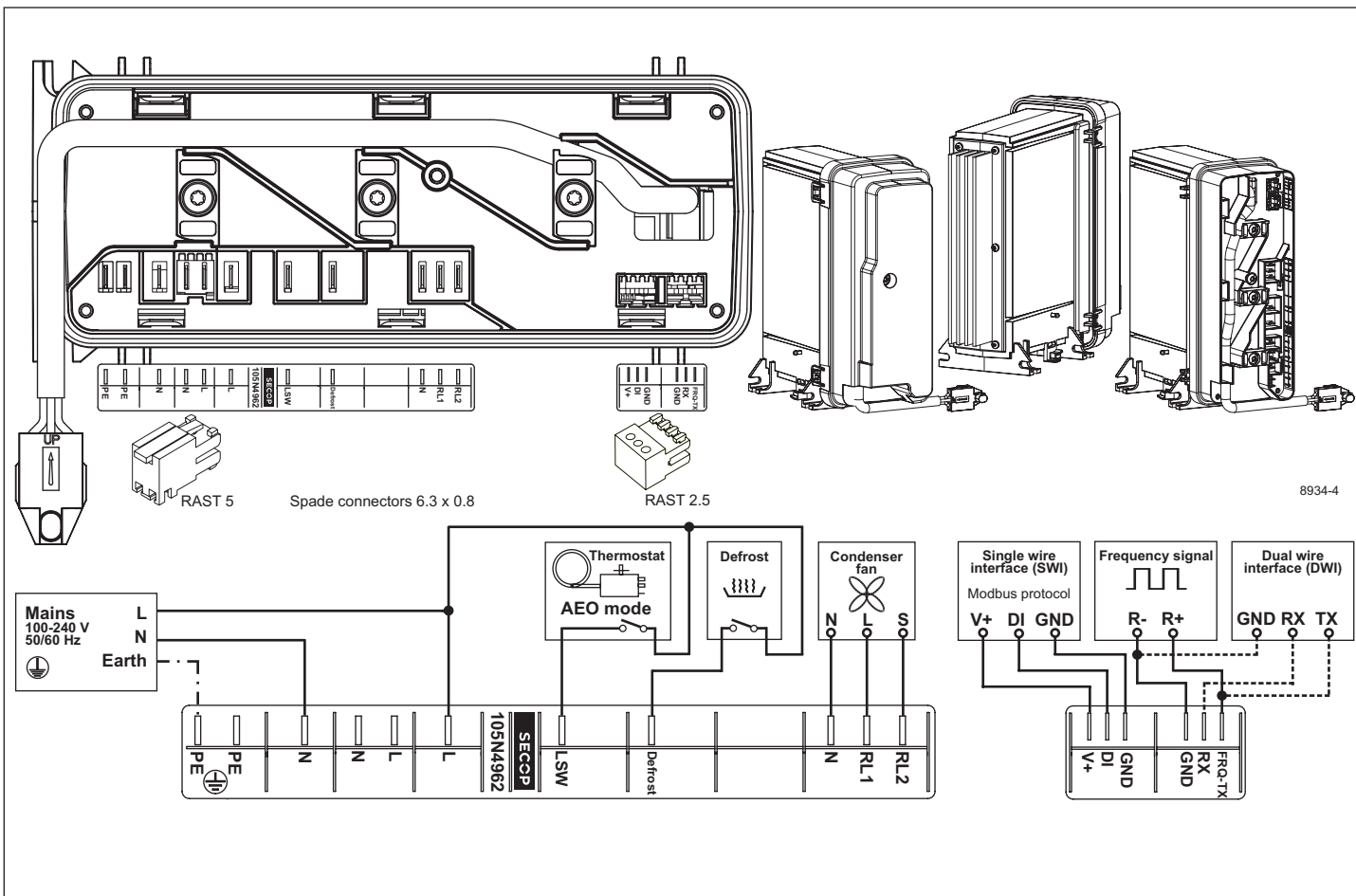
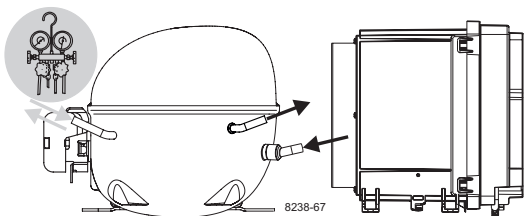

# Instructions

NLV Compressors  
100-240V 50/60Hz  
105N4962  
Controllers

**SECCP**



## Service/Repair R290



## Brazing on Suction Connectors (Direct Intake)

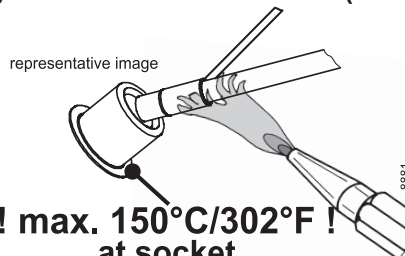

**! max. 150°C/302°F !  
at socket**  
brazing solder: phosphor (LP7) or silver  
Refer to Product Bulletin: **Brazing on Suction Connectors**  
(Compressors with Direct Suction Intake)

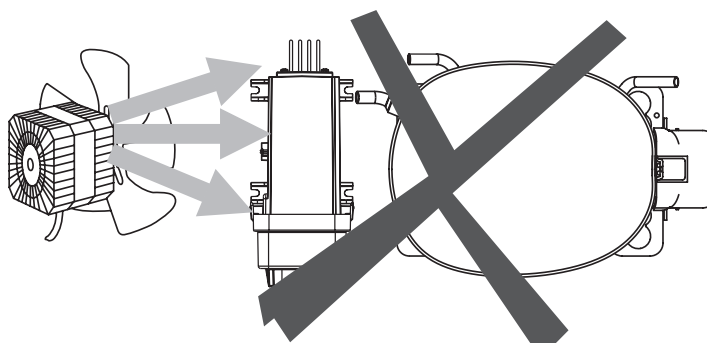
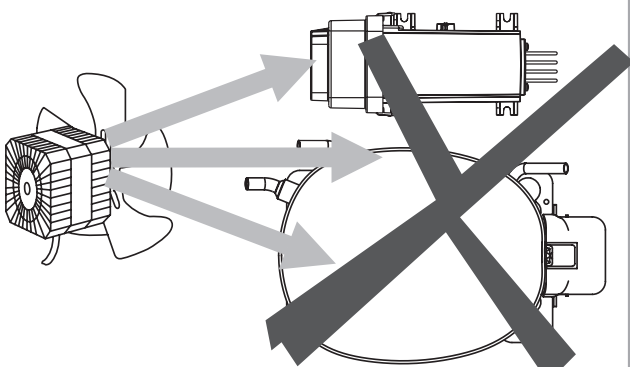
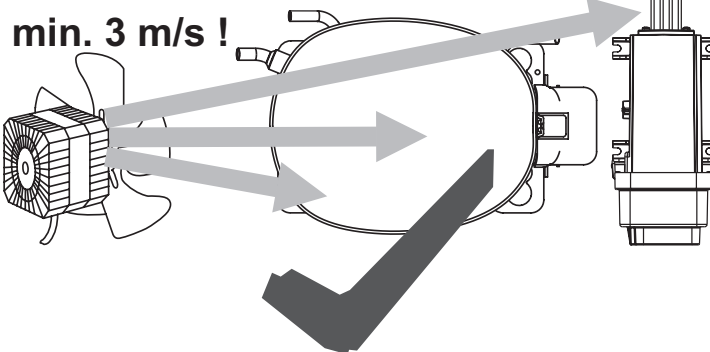
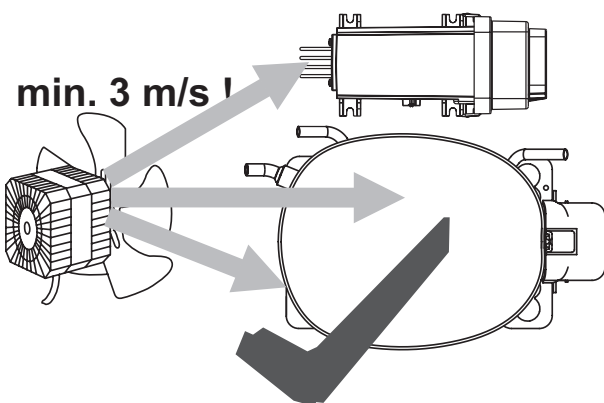

8938

<b>Airflow</b>	3 m/s
<b>Operating conditions</b>	+ 5 °C to 43 °C - humidity < 90 % rH non condensing
<b>Storage conditions</b>	-25 °C to 70 °C - humidity < 90 % rH non condensing
<b>Supply voltage</b>	100-240 V (± 10 %)
<b>Frequency</b>	50/60 Hz
<b>Input power, max.</b>	1000 W

Secop accepts no responsibility for possible errors in catalogs, brochures, and other printed material. Secop reserves the right to alter its products without notice. This also applies to products already on order provided that such alterations can be made without subsequent changes being necessary to specifications already agreed. All trademarks in this material are the property of the respective companies. Secop and the Secop logotype are trademarks of Secop GmbH. All rights reserved. [www.secop.com](http://www.secop.com)