

8238-82

Instructions

NLVE Compressors

115 V, 50/60 Hz

105N4100 Controllers

SECCP

Keep electrical equipment clear from oil, chemicals, and water

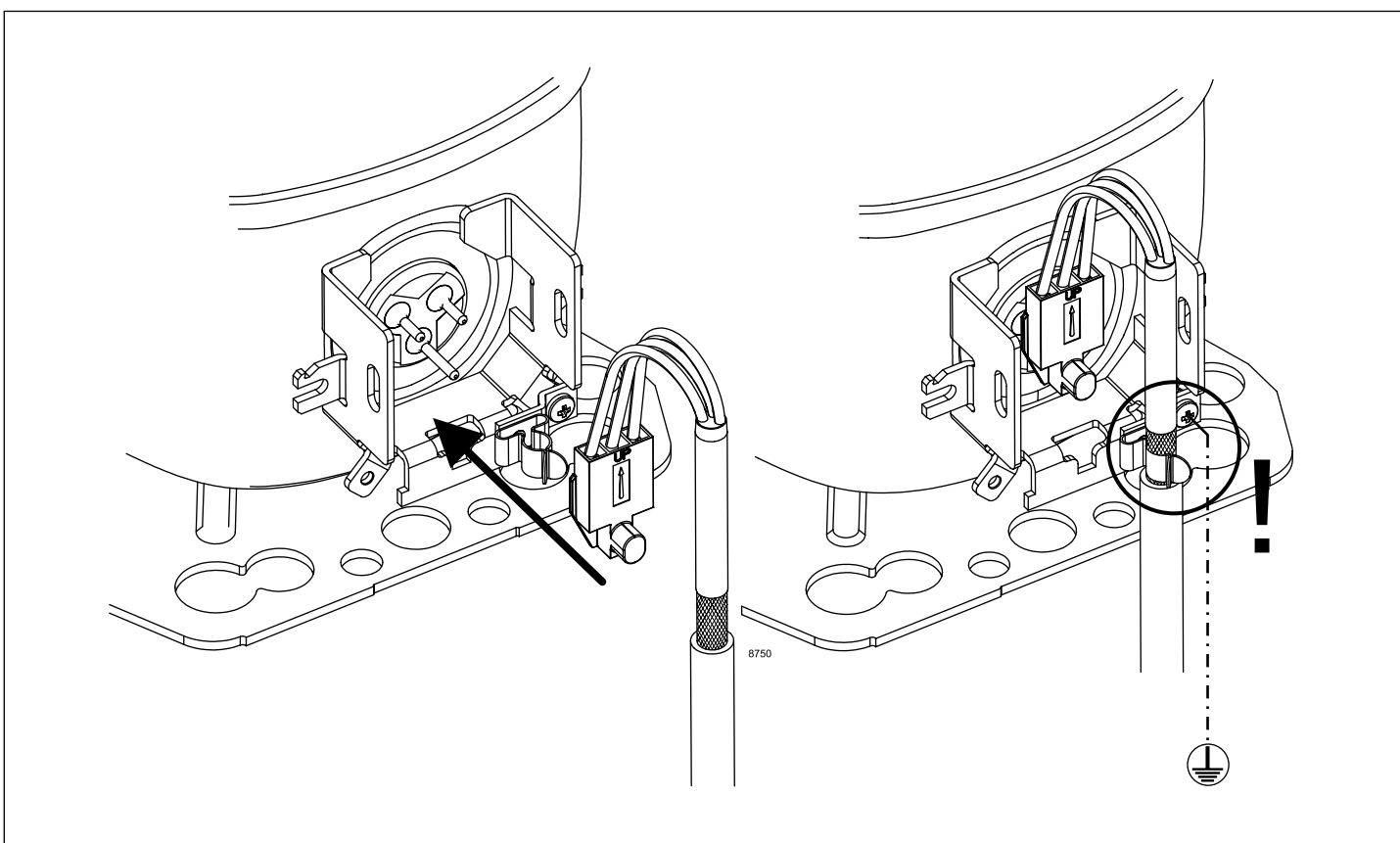
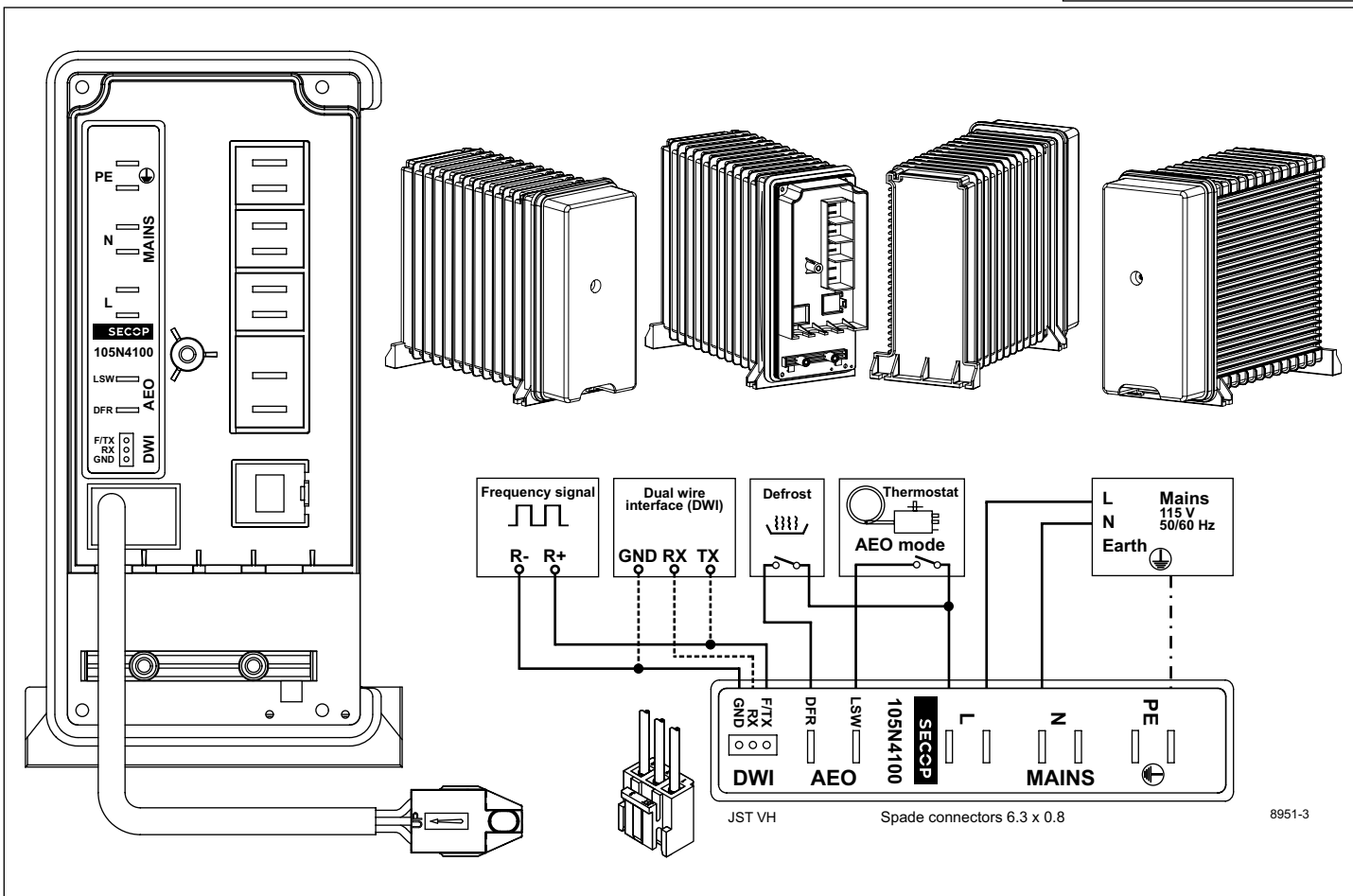

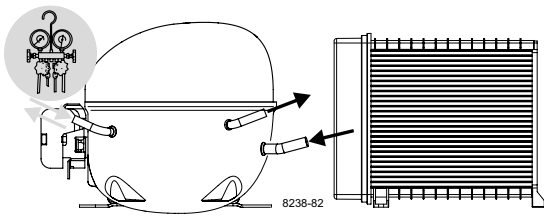

Instructions

NLVE Compressors
115 V, 50/60 Hz
105N4100 Controllers

SECCP

Keep electrical equipment clear from oil, chemicals, and water



Service/Repair – R170, R290, R1270 (applies to all flammable refrigerants)

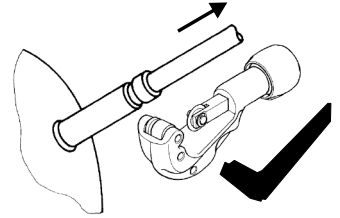
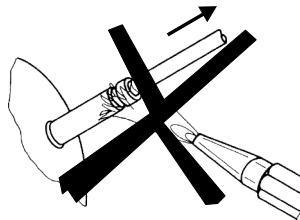

Ensure Proper Airflow of 3 m/s at Both Compressor and Electronic Unit (Heatsink)

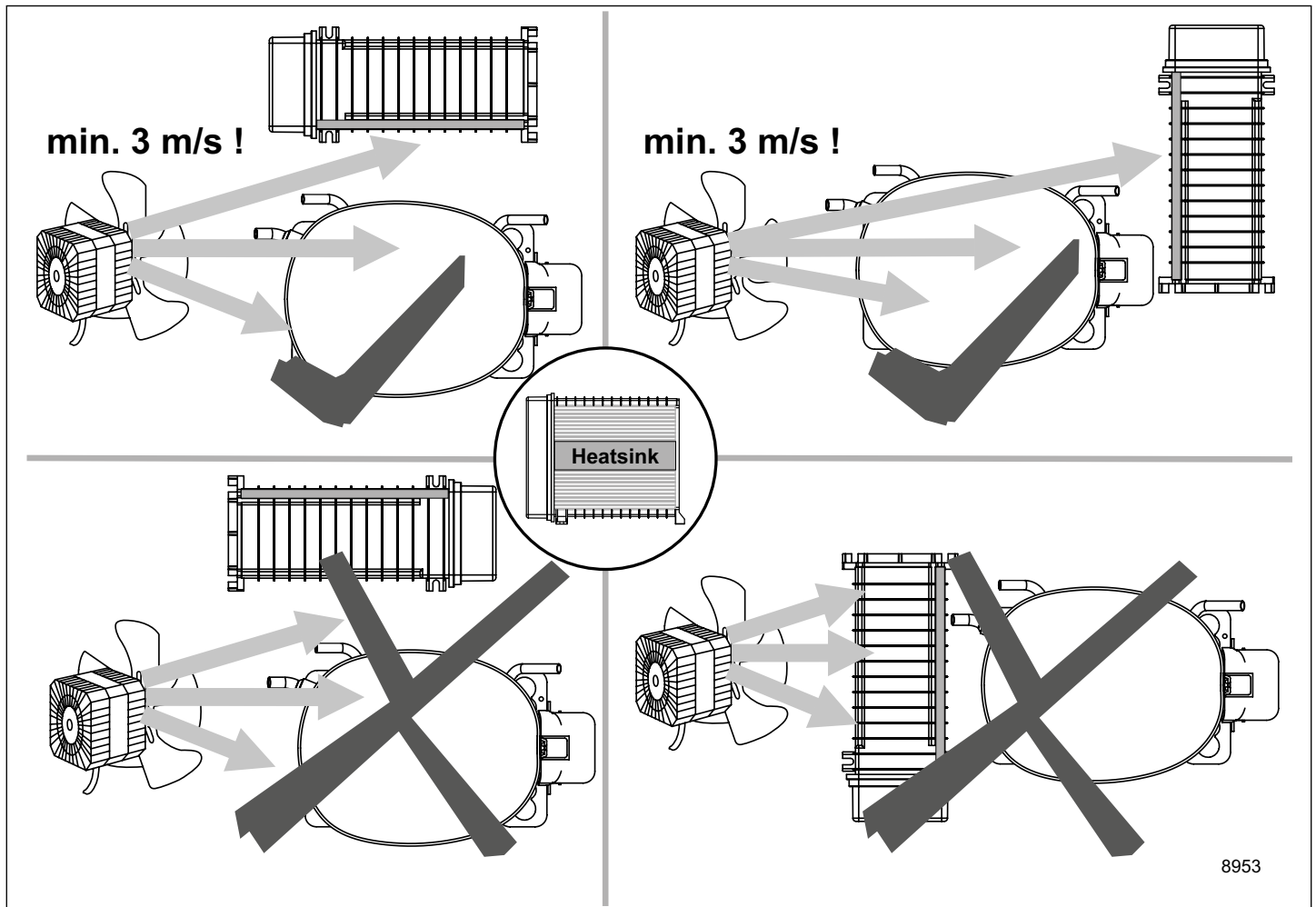

Airflow	3 m/s
Operating conditions	+ 5 °C to 43 °C - humidity < 90 % rH non condensing
Storage conditions	-25 °C to 70 °C - humidity < 90 % rH non condensing
Supply voltage	115 V (± 10 %)
Frequency	50/60 Hz
Input power, max.	1000 W

Dismantling, recycling, disposal: At the end of a compressor's lifecycle, proceed by separating and storing components according to their environmental impact. Parts that may cause pollution must be clearly identified and handled separately, ensuring appropriate disposal. Refrigerant gas must not be released into the environment and should be recovered by qualified operators. Compressor oil must also be collected separately. The compressor should be disposed of at specialized disposal centers in accordance with the applicable regulations. **Subject to modifications/alterations. www.seccp.com**