

Single Pack NLE13LNDX 220-240V 50Hz CSCR

Single pack code number: **195B4832**

Position	Title	Code	Amount
1	Compressor NLE13LNDX	105H7301	1
2	Start equipment NLE	117U8200	1
3	Starting capacitor (80 μ F 260V)	117U5353	1
4	Run Capacitor (10 μ F 450V, 6.3mm)	117-7166	1
5	Run capacitor bracket	117-0314	1
6	Cover NLE	117U1038	1
7	Cord relief	103N1007	1
8	Screw for bracket M4x8mm	117-0301	1
9	Bolt joint for one compressor M6 \varnothing 16mm	118-1917	1

Secop GmbH • Lise-Meitner-Straße 29 • 24941 Flensburg, Germany • Tel: +49 461 4941 0 • www.secop.com

Secop accepts no responsibility for possible errors in catalogs, brochures, and other printed material. Secop reserves the right to alter its products without notice. This also applies to products already on order provided that such alterations can be made without subsequent changes being necessary to specifications already agreed. All trademarks in this material are the property of the respective companies. Secop and the Secop logotype are trademarks of Secop GmbH. All rights reserved.

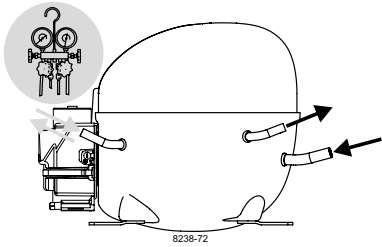

8238-72

NLE Plus Compressors

SECCP

Keep electrical equipment clear from oil, chemicals, and water



When operated with a flammable refrigerant, only spark-proof starting equipment is allowed.

CSCR

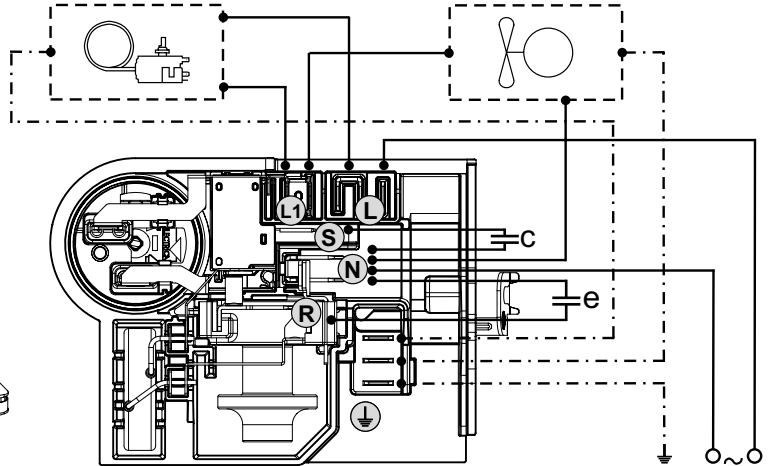
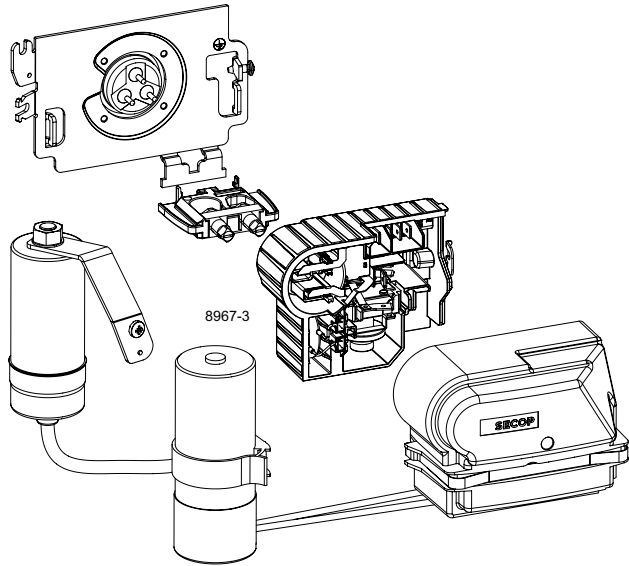

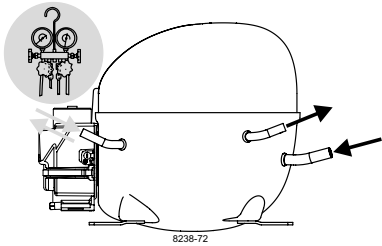

NLE Plus Compressors



Keep electrical equipment clear from oil, chemicals, and water



When operated with a flammable refrigerant, only spark-proof starting equipment is allowed.



Service/Repair – R290, R600a, R170, R1270, R1234yf (applies to all flammable refrigerants)

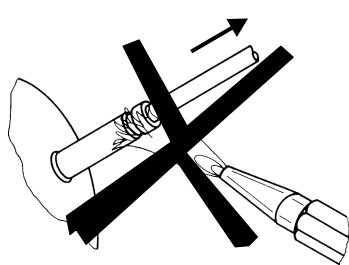

8545

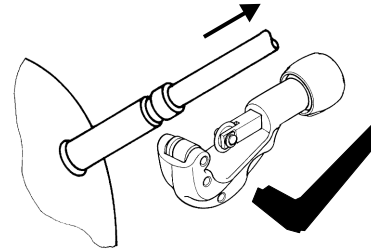

Dismantling, recycling, disposal: At the end of a compressor's lifecycle, proceed by separating and storing components according to their environmental impact. Parts that may cause pollution must be clearly identified and handled separately, ensuring appropriate disposal. Refrigerant gas must not be released into the environment and should be recovered by qualified operators. Compressor oil must also be collected separately. The compressor should be disposed of at specialized disposal centers in accordance with the applicable regulations. **Subject to modifications/alterations. www.seccp.com**